

Marsh Road and Station Approach,
Pinner proposed changes to the parking
layout and introduction of zebra
crossings

Statement of Reasons
Notice of Proposals
Draft Traffic Orders
Plan

Consultation Period
00:00 on 15th January 2026
to
23:59 on 4th February 2026

London Borough of Harrow

The Harrow (Waiting and Loading Restriction) (Amendment No. **) Traffic Order 20**,
The Harrow (Parking Places) (Amendment No. **) Traffic Order 20** and
The Harrow (Free Parking Places) (Amendment No. **) Traffic Order 20**

Ref: 25-46

Statement of Reasons

Zebra Crossing and Double Yellow Lines:

The introduction of a zebra crossing is proposed to provide a safe and convenient point for pedestrians to cross the road, improving accessibility and reducing the risk of collisions, particularly for vulnerable users such as children, older people, and those with mobility impairments. The crossing will support walking and cycling by improving connectivity between key destinations and enhancing overall road safety.

The installation of double yellow lines is required to prevent obstructive and unsafe parking, ensure clear visibility between pedestrians and approaching drivers, and allow vehicles to approach and exit the crossing safely. This will help maintain the effectiveness of the zebra crossing and reduce the likelihood of conflicts or accidents.

Together, these measures will improve pedestrian safety, maintain traffic flow, and contribute to a safer and more accessible street environment.

Increase in Permit Holder Parking Hours:

The increase in permit holder parking hours is proposed to improve the effective management of on-street parking and better reflect current demand and usage patterns. Extending the controlled hours will help prevent commuter and long-stay parking by non-permit holders, ensuring that parking spaces remain available for residents and legitimate permit holders.

The revised hours will improve compliance, reduce displacement parking, and support access for residents, visitors, and essential services. The proposal will also contribute to improved traffic flow, reduced congestion, and safer streets by discouraging inappropriate or obstructive parking.

Project Officer: Ben Murphy

Ends

LONDON BOROUGH OF HARROW

NOTICE OF INTENT – Highways Act 1980 (Section 23, Pedestrian Crossings) Proposed New Controlled (Zebra) Crossing at Marsh Road and proposed change of location of the Controlled (Zebra) Crossing at Station Approach, Harrow

Notice is hereby given that the London Borough of Harrow, ("the Council"), under the Highways Act 1980, intends to install a Zebra Controlled Crossing on Station Approach, Pinner, close to the junction with Marsh Road. This would upgrade the current pedestrian refuge at this location. The Council also intends to move the zebra crossing close to its north-western junction with Cecil Park westwards for 12 metres.

The introduction of a zebra crossing is proposed to provide a safe and convenient point for pedestrians to cross the road, improving accessibility and reducing the risk of collisions, particularly for vulnerable users such as children, older people, and those with mobility impairments. The crossing will support walking and cycling by improving connectivity between key destinations and enhancing overall road safety.

A copy of Council's statement of reasons for proposing these works and plans will be available until the expiration of a period of 21 days from the date on which this notice is published at Greenhill Library, Perceval Square, College Road, Harrow, HA1 1GX between 10.00 a.m. and 6.00 p.m. Monday to Saturday and 11.00 a.m. and 3.00 p.m. Sunday, excluding Bank Holidays. Copies are also available to view at www.harrow.gov.uk/trafficorders. quoting reference 25-46 BM. **The deadline for objections is 23.59 hours on 4th February 2026.**

Dated 15th January 2026

Poonam Pathak

Strategic Head of Traffic, Highways and Asset Management
Environment Directorate, PO Box 1362, Harrow, HA3 3RL

LONDON BOROUGH OF HARROW

The Harrow (Waiting and Loading Restriction) (Amendment No. **) Traffic Order 20**,
The Harrow (Parking Places) (Amendment No. **) Traffic Order 20** and
The Harrow (Free Parking Places) (Amendment No. **) Traffic Order 20**

1. NOTICE IS HEREBY GIVEN that the Council of the London Borough of Harrow proposes to make the above-mentioned Orders under sections 6, 45, 46, 49 and 124 of and Part IV of Schedule 9 to the Road Traffic Regulation Act 1984 as amended by the Local Government Act 1985 and all other enabling powers.
2. The general effect of the Orders will be to:
 - a) on the east side of **Marsh Road**, to convert 35.2 metres of single yellow line (hours of control: Monday to Saturday 8am to 6.30pm) outside Nos. 104 to 110 Marsh Road, to seven limited waiting bays (hours of control: Monday to Saturday 8am to 6.30pm. Maximum stay 3 hours, no return within 4 hours);
 - b) the east side of **Marsh Road**, to convert 8.3 metres of single yellow line (hours of control: Monday to Saturday 8am to 6.30pm) outside No. 112 Marsh Road, to 'at any time' waiting restrictions;
 - c) on the west side of **Marsh Road**, to convert 5.6 metres of single yellow line (hours of control: Monday to Saturday 8am to 6.30pm) outside Nos. 139/151 Marsh Road, to one shared use parking bay (hours of control: Monday to Saturday 8am to 6.30pm. Maximum stay 3 hours, no return within 4 hours, or Permit A holders);
 - d) the west side of **Marsh Road**, to convert one shared use parking bay (hours of control: Monday to Saturday 8am to 6.30pm. Maximum stay 2 hours, no return within 4 hours, or Permit A holders) outside No. 143 Marsh Road, to 5.6 metres of 'at any time' waiting restrictions and build out;
 - e) on the west side of **Marsh Road**, to extend the maximum stay of the ten shared-use bays outside Nos. 145 to 171 from 2 hours to 3 hours;
 - f) on the west side of **Marsh Road**, to extend the maximum stay of the six shared-use bays outside Nos. 185 to 211 from 2 hours to 3 hours;
 - g) on the **northern junction of Marsh Road and the Chapel Lane Car Park access road**, to convert 23.4 metres of single yellow line (hours of control: Monday to Saturday 8am to 6.30pm), to 'at any time' waiting restrictions; and
 - h) on the west side of **Marsh Road**, to convert 9.0 metres of single yellow line (hours of control: Monday to Saturday 8am to 6.30pm) under the railway bridge, to 'at any time' waiting restrictions.
3. A copy of the proposed Orders, maps of the relevant areas and the Council's statement of reasons for proposing to make the Order can be inspected until the expiration of a period of 21 days from the date on which this notice is published at Greenhill Library, Perceval Square, College Road, Harrow, HA1 1GZ between 10.00 a.m. and 6.00 p.m. on Monday to Saturday and 11.00 a.m. and 3.00 p.m. Sunday, excluding Bank Holidays.
4. Further information may be obtained by contacting the Transportation Service at transportation@harrow.gov.uk.
5. Persons desiring to make representations should send a statement in writing giving the grounds thereof to the Head of Traffic, Highways and Asset Management at transportation@harrow.gov.uk quoting reference 26-01 TB, within 21 days from the date on which this notice is published. **The deadline for objections is 23.59 hours on 4th February 2026.**

Dated 15th January 2026

Poonam Pathak

Strategic Head of Traffic, Highways and Asset Management
Environment Directorate, PO Box 1362, Harrow, HA3 3RA

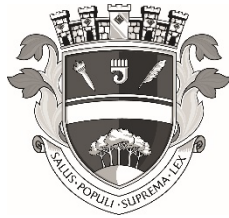

LONDON BOROUGH OF **HARROW**

TRAFFIC MANAGEMENT ORDER

2025 No. **

The Harrow (Waiting and Loading Restriction) (Amendment No. **) Traffic Order 2025

Made **

Coming into operation **

The Council of the London Borough of Harrow, after consulting the Commissioner of Police for the Metropolis, in exercise of the powers conferred by sections 6, 124, and Part IV of Schedule 9 to the Road Traffic Regulation Act 1984(a) and of all other powers thereunto enabling, hereby make the following Order:-

1. This Order shall come into operation on ** and may be cited as The Harrow (Waiting and Loading Restriction) (Amendment No. **) Traffic Order 2025.
2. In this Order the expression "enactment" means any enactment, whether public general or local, and includes any order, byelaw, rule, regulation, scheme or other instrument having effect by virtue of an enactment and any reference in this Order to any enactment shall be construed as a reference to that enactment as amended, applied, consolidated, re-enacted by or as having effect by virtue of any subsequent enactment.
3. Without prejudice to the validity of anything done or to any liability incurred in respect of any act or omission before the coming into operation of this Order, the Harrow (Waiting and Loading Restriction) Traffic Order 2014(c) shall have effect as though the item in Schedule 1 to that Order numbered 601 there was substituted the item similarly numbered and set out in columns 1, 2 and 3 of the Schedule to this Order.

Dated this **

Poonam Pathak
Strategic Head of Traffic, Highways & Asset Management
(the officer appointed for this purpose)

(a) 1984 c.27

(b) 1985 c.51

(c) LBH2014/40

SCHEDULE 1

1 Item No.	2 Street	3 Prescribed hours see Schedule
601	<p>Marsh Road</p> <p>(a) the east, north-east and north sides,</p> <p>(i) between its junction with High Street, Pinner, and a point 30 metres north of the northern boundary wall of No. 120 Marsh Road;</p> <p>(ii) between a point 30.00 metres north of the northern boundary wall of No. 120 Marsh Road and a point 4 metres south of the common boundary of Nos. 120 & 118 Marsh Road;</p> <p>(iii) between a point 4.0 metres south of the common boundary of Nos. 120 & 118 Marsh Road and a point 35.2 metres north of the common boundary of Nos. 102 and 104 Marsh Road;</p> <p>(iv) between a point opposite the common boundary of Nos. 102 and 104 Marsh Road, and a point opposite the common boundary of Nos. 94 and 96 Marsh Road;</p> <p>(v) between a point opposite the common boundary of Nos. 94 and 96 Marsh Road, and a point 10.00 metres north-west of the extended north-western kerb-line of Cecil Park;</p> <p>(vi) between a point 10.00 metres north-west of the extended north-western kerb-line of Cecil Park and a point 9.00 metres south-east of the extended south-eastern kerb-line of Cecil Park;</p> <p>(vii) between a point 9.00 metres south-east of the extended south-eastern kerb-line of Cecil Park and a point 7.50 metres north-west of a point opposite the common boundary of Nos. 70 and 74 Marsh Road;</p> <p>(viii) between a point 7.50 metres north-west of a point opposite the common boundary of Nos. 70 and 74 Marsh Road and a point opposite the common boundary of Nos. 62 and 64 Marsh Road;</p> <p>(ix) between a point opposite the common boundary of Nos. 62 and 64 Marsh Road and a point opposite the extended north-western kerb-line of Grove Avenue;</p> <p>(x) between a point opposite the extended north-western kerb-line of Grove Avenue point a point 5.40 metres east of a point opposite the common boundary of Nos. 36 and 38 Marsh Road;</p> <p>(xi) between a point 5.40 metres east of a point opposite the common boundary of Nos. 36 and 38 Marsh Road and a point opposite the rear property boundary of No. 28 Marsh Road;</p> <p>(xii) between a point opposite the rear property boundary of No. 28 Marsh Road and a point 5.00 metres south-west of the south-western property boundary of No.1 The Chase;</p> <p>(xiii) from its northern property boundary of No. 215 (Monument House) Marsh Road, in a southerly direction for 20.8 metres;</p>	<p>A</p> <p>E</p> <p>A</p> <p>A</p> <p>E</p> <p>A</p> <p>E</p> <p>A</p> <p>E</p> <p>U</p> <p>A</p> <p>U</p> <p>A</p>

1 Item No.	2 Street	3 Prescribed hours see Schedule
	<p>(xiv) from a point 20.8 metres south of the northern property boundary of No. 215 (Monument House) Marsh Road, to its northern extended kerb line of Chapel Lane Car Park access Road;</p> <p>(xv) between a point 2.90 metres south of a point opposite the party wall of Nos. 2 and 4 Marsh Road and a point opposite the common boundary of No. 2 Marsh Road and No. 1 Nower Hill.</p> <p>(b) the west, south-west and south sides,</p> <p>(i) between its junction with Bridge Street and a point 25.00 metres north of a point opposite the northern wall of No. 120 Marsh Road;</p> <p>(ii) between a point 25.00 metres north of a point opposite the southern wall of No. 120 Marsh Road and the northern property boundary of No. 215 (Monument House) Marsh Road;</p> <p>(iii) between the southern kerb-line of the access road to Chapel Lane car park and its southern junction with the service road fronting Nos. 137 to 183 Marsh Road;</p> <p>(iv) between its southern junction with the service road fronting Nos. 137 to 183 Marsh Road and a point 7.50 metres north-west of a point opposite the common boundary of Nos. 70 and 74 Marsh Road;</p> <p>(v) between a point 7.50 metres north-west of a point opposite the common boundary of Nos. 70 and 74 Marsh Road and a point opposite the common boundary of Nos. 62 and 64 Marsh Road;</p> <p>(vi) between a point opposite the common boundary of Nos. 62 and 64 Marsh Road and a point 1.30 metres south-east of a point opposite the common boundary of Nos. 50 and 52 Marsh Road;</p> <p>(vii) between a point 1.30 metres south-east of a point opposite the common boundary of Nos. 50 and 52 Marsh Road and a point opposite the common boundary of Nos. 46 and 48 Marsh Road;</p> <p>(viii) between a point opposite the common boundary of Nos. 46 and 48 Marsh Road and a point 14.00 metres west of the extended western kerb-line of the access road to Nos. 47 to 69 Marsh Road;</p> <p>(ix) between a point 14.00 metres west of the extended western kerb-line of the access road to Nos. 47 to 69 Marsh Road and a point 24.00 metres west of a point opposite the common boundary of No. 37 Marsh Road and Marsh Point, Marsh Road;</p> <p>(x) between a point 24.00 metres west of a point opposite the common boundary of No. 37 Marsh Road and Marsh Point,</p>	<p>E</p> <p>U</p> <p>A</p> <p>E</p> <p>A</p> <p>E</p> <p>A</p> <p>E</p> <p>A</p> <p>E</p> <p>A</p> <p>U</p>

1 Item No.	2 Street	3 Prescribed hours see Schedule
	<p>Marsh Road, and a point 5.00 metres south-west of the south-western property boundary of No.1 The Chase;</p> <p>(xi) between a point 3.20 metres north-east of a point opposite the party wall of Nos. 1 and 3 Marsh Road and its junction with Pinner Road;</p> <p>(xii) from its northern property boundary of No. 215 (Monument House) Marsh Road, in a southerly direction for 20.8 metres;</p> <p>(xiii) from a point 20.8 metres south of the northern property boundary of No. 215 (Monument House) Marsh Road, to its northern extended kerb line of Chapel Lane Car Park access Road;</p> <p>(c) the service road fronting Nos. 137 to 183 Marsh Road;</p> <p>(i) the south-west side,</p> <p>(A) between its junction with West End Avenue and a point 1.80 metres north-west of a point opposite the north-western wall of No. 183 Marsh Road;</p> <p>(B) between a point 1.80 metres north-west of a point opposite the north-western wall of No. 183 Marsh Road and a point 22.8 metres north of the southern building line of Nos. 137 Marsh Road;</p> <p>(C) between a point 22.8 metres north of the southern building of No. 137 Marsh Road and a point 17.0 metres north of that building line;</p> <p>(D) between a point xx metres north of the southern building of No. 137 Marsh Road and its south-eastern extremity.</p> <p>(ii) the north-east side.</p> <p>(d) the service road fronting Nos. 185 to 211 Marsh Road;</p> <p>(i) the south-west side,</p> <p>(A) between the extended south-eastern kerb-line of the access road to Chapel Lane car park and a point 3.10 metres south-east of that extended kerb-line;</p> <p>(B) between a point 3.10 metres south-east of the extended south-eastern kerb-line of the access road to Chapel Lane car park and a point 24.00 metres south-east of that point;</p> <p>(C) between a point 27.10 metres south-east of the extended south-eastern kerb-line of the access road to Chapel Lane car park and a point 5.10 metres south-east of that point;</p> <p>(D) between a point 32.20 metres south-east of the extended south-eastern kerb-line of the access road to Chapel Lane car park and a point 4.40 metres north-west of a point opposite the south-eastern flank wall of No. 197 Marsh Road;</p> <p>(E) between a point 4.40 metres north-west of a point opposite the south-eastern flank wall of No. 197 Marsh Road and its junction with West End Avenue;</p> <p>the north-east side.</p>	<p>A</p> <p>A</p> <p>A</p> <p>A</p> <p>E</p> <p>A</p> <p>A</p> <p>E</p> <p>E</p> <p>A</p> <p>A</p> <p>E</p> <p>A</p>

EXPLANATORY NOTE

(This Note is not part of the Order, but is intended to indicate its general purport.)

This Order further amends The Harrow (Waiting and Loading Restriction) Order 2014, so to amend the hours of control in certain lengths of the carriageway within Marsh Road, Pinner.

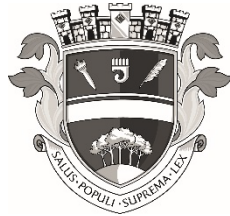

LONDON BOROUGH OF **HARROW**

TRAFFIC MANAGEMENT ORDER

20** No. *

The Harrow (Parking Places) (Amendment No. *) Traffic Order 20**

Made **

Coming into operation **

The Council of the London Borough of Harrow, after consulting the Commissioner of Police of the Metropolis, in exercise of the powers conferred by sections 45, 46, 49 and 124 and Part IV of Schedule 9 to the Road Traffic Regulation Act 1984(a) and of all other powers thereunto enabling, hereby make the following Order:

1. This Order shall come into operation on *** and may be cited as The Harrow (Parking Places) (Amendment No.***) Traffic Order 20**.
2. In this Order the expression “enactment” means any enactment, whether public general or local, and includes any order, byelaw, rule, regulation, scheme or other instrument having effect by virtue of an enactment and any reference in this Order to any enactment shall be construed as a reference to that enactment as amended, applied, consolidated, re-enacted by or as having effect by virtue of any subsequent enactment.
3. Without prejudice to the validity of anything done or to any liability incurred in respect of any act or omission before the coming into operation of this Order, The Harrow (Parking Places) Traffic Order 2020(b) shall have effect as though for the item numbered 1 in Table 1 of Part 4 of Schedule 3 to that Order there were substituted the item similarly numbered and set out in Schedule 1 to this Order;

Dated this ** day of ** 20**

Poonam Pathak
Strategic Head of Traffic, Highways & Asset Management
(the officer appointed for this purpose)

(a) 1984 c.27

(b) LBH2020/17

PART 4 - SHARED USE PARKING PLACES (See Article 31)

TABLE 1 – PARKING PLACES

In relation to a parking place in this table the expression “permitted hours” means the period between 8am and 6.30pm on Monday to Saturday inclusive of any bank holidays falling on those days. Parking places in which a vehicle may be left during the “permitted hours” with;

- (1) payment of the parking charge is registered electronically via the parking system. Payment is to be made on each visit; or,**
- (2) a valid resident permit, business permit, trader's permit, resident visitor permit, carer's permit or Doctors permit for Zone A, or a valid health care permit.**

1 Item No. Parking Place	2 Designated Parking Place	3 Maximum No. of parking spaces	4 Special manner of standing
1	<p>Marsh Road</p> <p>(a) the service road fronting Nos. 137 Marsh Road, the south-west side,</p> <p>(i) between a point 1.80 metres south-east of a point 22.3 metres north of the southern building line of No. 137 Marsh Road, and a point 1.7 metres north-west of a point opposite the north-western wall of Nos. 171 and 183 Marsh Road;</p> <p>(ii) between a point 10.1 metres north of the southern building line of No. 137 Marsh Road and a point 4.5 metres north of that building line;</p> <p>(b) the service road fronting Nos. 185 to 211 Marsh Road, the south-west side, between a point 4.40 metres north-west of a point opposite the south-eastern flank wall of Nos. 197 and 199 Marsh Road and a point 3.10 metres south-east of the extended south-eastern kerb-line of the access road to Chapel Lane car park.</p>	<p>10</p> <p>1</p> <p>6</p>	

TABLE 2 - CHARGES AND TIME LIMITS

1	The parking charge for a parking place listed in Table 1 shall be:	free for the first 1 hour subject to a maximum of 1 free period per day per vehicle in any on-street paid for parking place within the London Borough of Harrow. Thereafter the charge will be £1.40 per 60 minutes or part thereof.
2	The maximum period a vehicle may stay in the parking place listed in Table 1 shall be:	3 hours, no return within 4 hours

EXPLANATORY NOTE

(This Note is not part of the Order, but is intended to indicate its general purport.)

This Order further amends The Harrow (Parking Places) Traffic Order 2020, so as to redesignate parking places within Marsh Road, Pinner.



LONDON BOROUGH OF
HARROW

TRAFFIC MANAGEMENT ORDER

2026 No. *

The Harrow (Free Parking Places) (Amendment No. *) Traffic Order 20**

Made **

Coming into operation **

The Council of the London Borough of Harrow, after consulting the Commissioner of Police of the Metropolis, in exercise of the powers conferred by sections 45, 46, 49 and 124 and Part IV of Schedule 9 to the Road Traffic Regulation Act 1984(a) and of all other powers thereunto enabling, hereby make the following Order:

1. This Order shall come into operation on *** and may be cited as The Harrow (Free Parking Places) (Amendment No.***) Traffic Order 20**.
2. In this Order the expression “enactment” means any enactment, whether public general or local, and includes any order, byelaw, rule, regulation, scheme or other instrument having effect by virtue of an enactment and any reference in this Order to any enactment shall be construed as a reference to that enactment as amended, applied, consolidated, re-enacted by or as having effect by virtue of any subsequent enactment.

3. Without prejudice to the validity of anything done or to any liability incurred in respect of any act or omission before the coming into operation of this Order, The Harrow (Free Parking Places) Traffic Order 2016(b) shall have effect as though there was added to Schedule 8 to that order, the item numbered ** in the Schedule to this Order;

Dated this ** day of ** 2026

Poonam Pathak

Strategic Head of Traffic, Highways & Asset Management
(the officer appointed for this purpose)

(a) 1984 c.27

(b) LBH2016/29

SCHEDULE

In relation to a parking place referred to in this table the maximum period a vehicle may stay will be 3 hours with no return within 4 hours.

No. of parking place 1	Designated Parking Place 2	Times of operation 3	Special Manner of Standing 4
**	MARSH ROAD the east side, between a point 35.3 metres north of a point in line with the common boundary of Nos. 102 and 104 Marsh Road, a point in line with that common boundary.	8.00am – 6.30pm Monday - Saturday	None

EXPLANATORY NOTE

(This Note is not part of the Order but is intended to indicate its general purport.)

This Order further amends The Harrow (Free Parking Places) Traffic Order 2016, so as to introduces seven parking places within Marsh Road, Pinner.

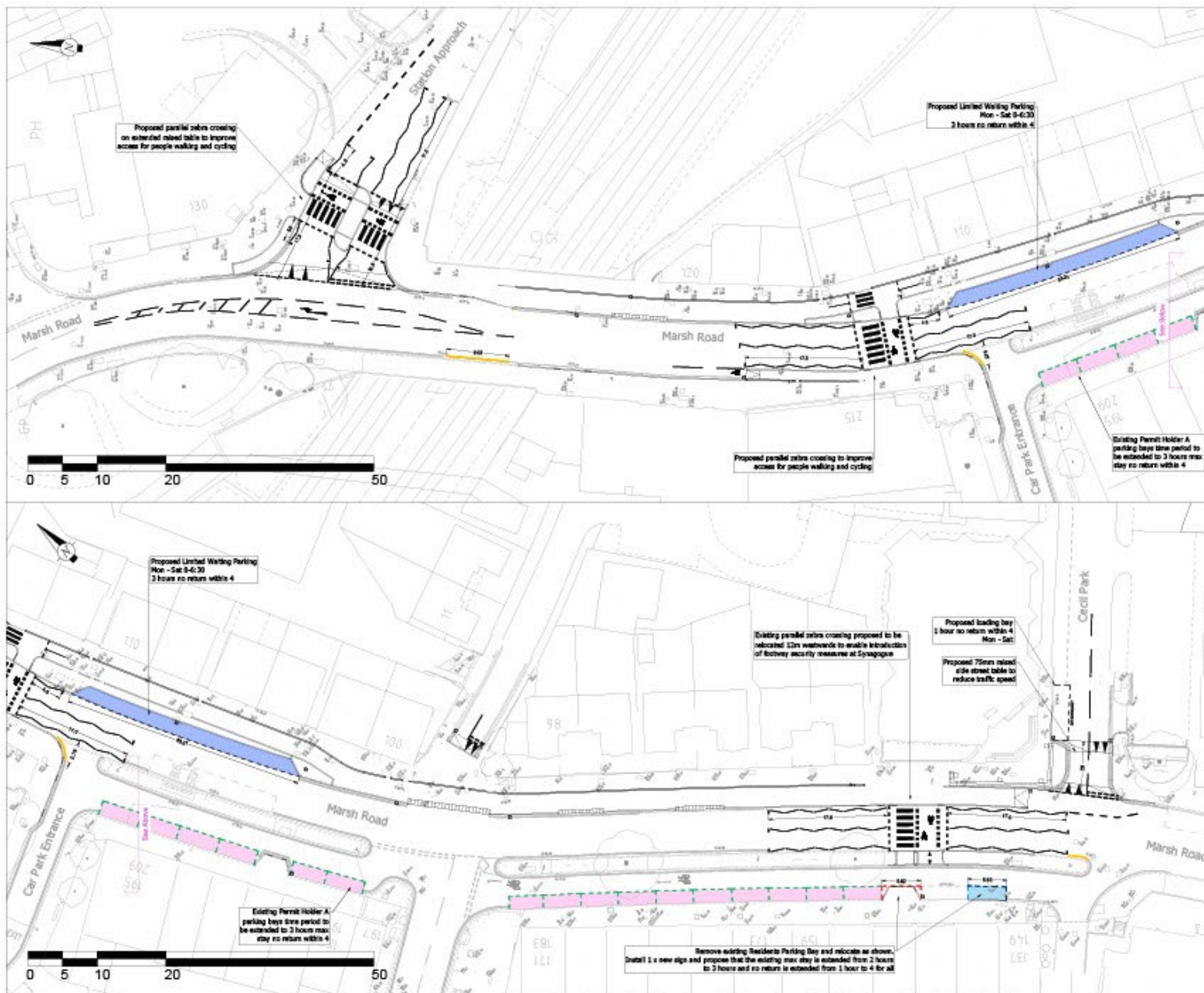

NOTES:
 1. Do not scale from this drawing.
 2. All dimensions in metres unless stated otherwise.

Key

- Proposed kerb line
- Existing yellow line marking
- Proposed double no waiting at any time restriction
- Proposed relocated Permit Holder A parking bay
- Existing Permit Holder A parking bays time period to be extended to 3 hours max stay no return within 4
- Proposed Limited Waiting (Mon - Sat 9-6:30, 3 hours no return within 4)

This map is reproduced from an earlier map and may not be up to date with the current status of the road. It is not intended to be used as a legal document. It is for information only. The London Borough of Harrow is not responsible for any errors or omissions. It is not intended to be used as a legal document. It is for information only.

LONDON BOROUGH OF HARROW
 ENVIRONMENT DIRECTORATE
 TRANSPORTATION
 P.O. Box 1002
 Harrow, Middlesex, HA1 2RN
 Tel: 020 8445 8111

Rev	Description	Date	By
1	Original	10/12/23	BU
2	Original	11/12/23	BU
3	Original	11/12/23	BU
4	Original	12/12/23	BU
5	Original	12/12/23	BU
6	Original	12/12/23	BU

Designation: Details of Revision: Date: Sign:

Marsh Road

TMO DRAFTING PLAN

Scale: 1:200
 Drawn: BU
 Checked: LU
 Date: 10/12/23
 Drawing no:
 Autocad file: