







Note:
All drawings to be read in conjunction with all other drawings as noted on issue sheet.
Extent of Site Boundary indicated thus: ————
Signage: All proposed signs noted on drawing including illuminated and method of illumination. Refer to drawing 11 for setting out positions.
See diag 15 for Signage Details
See diag 10 for Patio Details
See diag 12 for Ducts & Services Details

Schedule of Areas	
Existing Site Area	0.3303 ha
Existing Building (GFA / m ²) (Excluding Corral, Freezer/Chiller)	406 m ²
Proposed Site Area	0.3303 ha
Proposed Building (GFA / m ²) (Excluding Corral, Freezer/Chiller)	406 m ²
Proposed Building (GFA / m ²)	102 m ²

Schedule of Parking	
Existing Grill Bays	2 Bays
Existing Accessible Bays	2 Bays
Existing General Bays	46 Bays
Existing Total Bays	50 Bays
Proposed Grill Bays	2 Bays
Proposed Accessible Bays	2 Bays
Proposed General Bays	43 Bays
Proposed Total Bays	47 Bays

KEY - Proposed External	
	Existing Relocated
	New Surface As Indicated
	New Concrete Surface
	New Paving
	New Extension
	New Fence

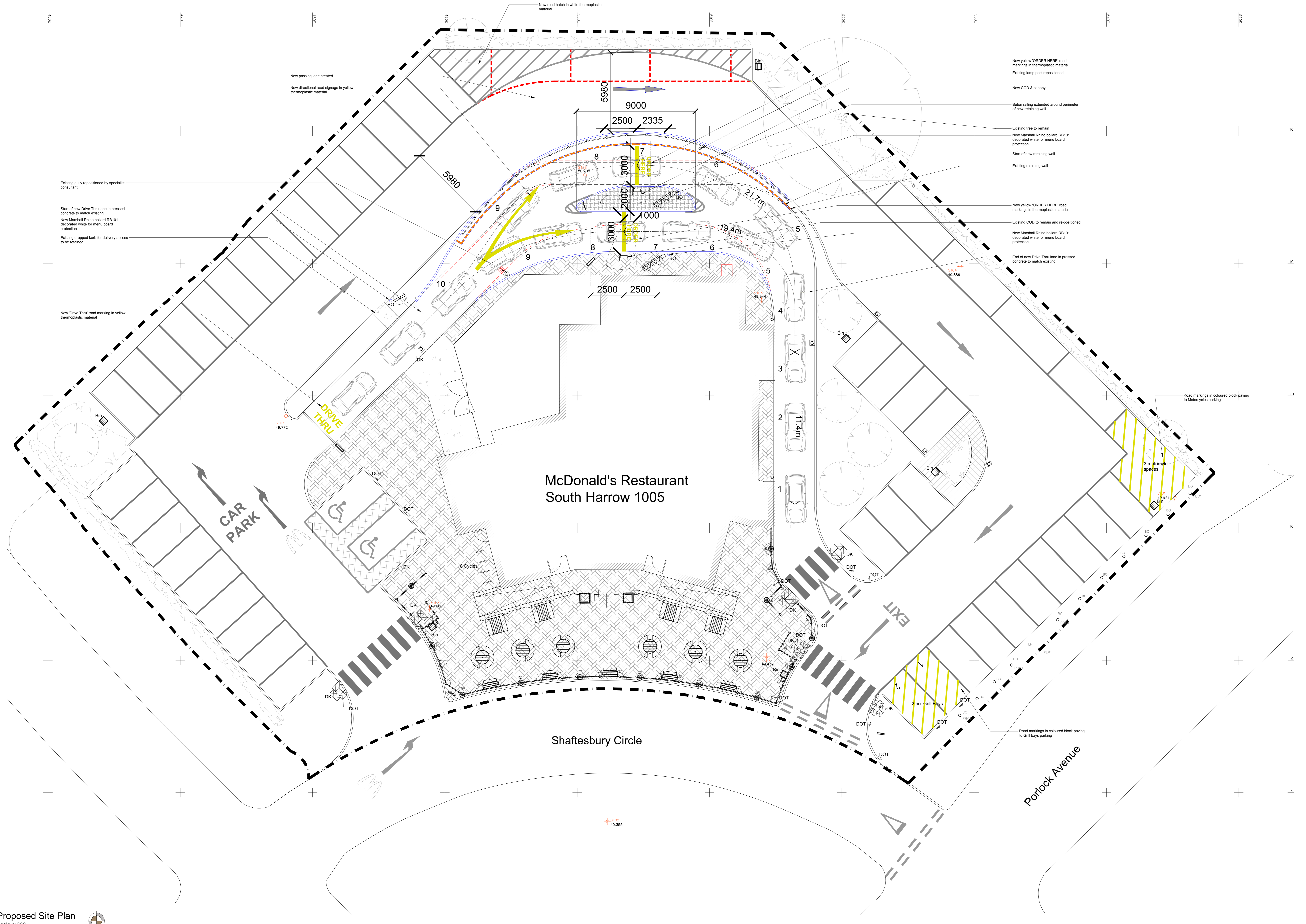
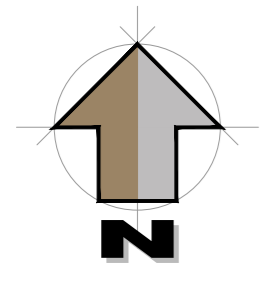

McDonald's Restaurant
South Harrow 1005

Shaftesbury Circle

Portlock Avenue

ERDDS
SALOON

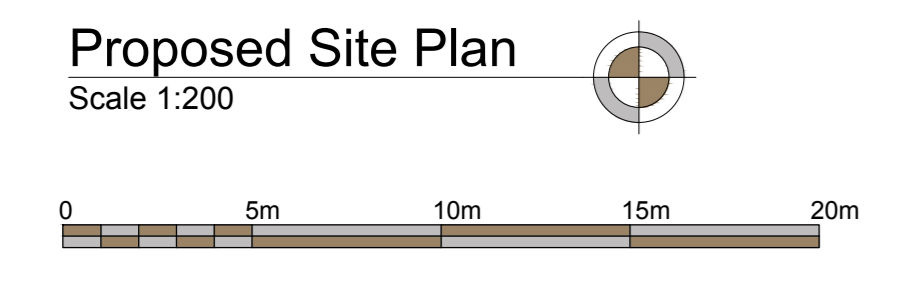

REV	DATE	DESCRIPTION	BY	CHK
1	07-05-15	Final Issue	CF	CF
2	07-05-15	090 Drive Thru lane added	CF	CF
3	07-05-15	Final Issue	CF	CF

GENERAL NOTES
All works are to be undertaken in accordance with the Building Regulations and the latest British Standards.
All proposed materials and products are to be used strictly in accordance with the manufacturer's recommendations.
All dimensions to be checked on site prior to construction.

McDonald's Restaurant Ltd
1005

Proposed Site Plan
(Scale by 250x Option)

DATE: 07-05-15
PROJECT: 0912-1005-300
DRAWING NO: 02-05-13

MARKETING EQUIPMENT	No.
DIGITAL WINDOW POSTER	-
DIGITAL PRICE MENU	REMOVED
DIGITAL COMMUNITY BOARD	REMOVED
M: CAFE SCREEN	REMOVED
50" PORTRAIT PROMOTIONAL SCREENS	2

SERVICE PLATFORM	No.
SERVICE TILLS	1
COTF SERVICE WINDOW SIZE (mm)	2100
SELF ORDER KIOSKS	4 - EXISTING

AREAS SCHEDULE	EXISTING	PROPOSED
GF COVERS	97	94
FF COVERS	-	-
TOTAL COVERS	97	94
APPROX' DINING AREA GIA	160.3 m ²	149.3 m ²
APPROX' WC GIA	16.2 m ²	16.2 m ²
APPROX' CREW ROOM GIA	25.6 m ²	25.6 m ²

DRAWINGS BASED ON:
SURVEY:
 OTHER: 7077_AEW_1005_0050L PROPOSED GA
 H&K DIN-26896 UK1005 SOUTH HARROW MFY Rev H

GENERAL	2017.06
PARTITIONS & LOW SCREENS - REFER TO FINISHES PLAN & RCP	
RECYCLING UNIT	IN SCHEME SPECIFIC FINISHES R1 UNIT SIZE: 1350mm x 960mm R2 UNIT SIZE: 1300mm x 960mm
SCREENING UNITS	FULL COVERTMENT UNIT 1500x900mm (H/WHEELS) STRAWNS, WAPINGS & GASTRONOMIE 1500x900mm (WALL FEEDS) STRAWNS & WAPINGS UNIT 1500x900mm (WALL FEEDS) STRAWNS & WAPINGS UNIT (IN STORES) 1800x900mm (WALL FEEDS)
SUNBURN ITEMS	CHILDREN'S HIGH CHAIR CHROME COUNTER GRATE RECYCLO-COLOURING BOARD 150 X 100mm BOARD

ALPHABET	FURNITURE	2017.04
#	ENIGMA LAMINATE OR GRAPHIC PRINTED ON PLYWOOD LAMINATED	AVAILABLE IN 300, 300x300, 300x300x1250mm (2014) (2014) 300x300x1250mm (2014)
#	ENIGMA LAMINATE OR GRAPHIC PRINTED ON PLYWOOD LAMINATED	AVAILABLE IN 300, 300x300, 300x300x1250mm (2014) (2014) 300x300x1250mm (2014)
#	HIGH STOOD - FLOOR MOUNTED PLYWOOD STOOL - FLOOR AVAILABLE IN 1100, 1100x1100, 1100x1100x1100mm (2014) (2014) 1100x1100x1100mm (2014)	
#	NEW 27" PAM SCREEN MOUNTED AT HIGH LEVEL	
#	NEW STEEL STRUCTURE TO SUPPORT THE WALLS AT THE FIRST FLOOR ABOVE TO BE REVIEWED BY A STRUCTURAL ENGINEER	
#	NEW CEILING MOUNTED ORB TO BE INSTALLED	
#	NEW DELIVERY COUNTER, TILL AND DELIVERY TABLET	
#	NEW EXTERNAL WALL TO FORM EXTENDED COURIER WAITING AREA	
#	NEW WINDOW WITH FROSTED, OBSCURED GLASS	
#	NEW INTERNAL WALLS BUILT TO FORM A NEW DELIVERY AREA & ORDER COLLECTION AREA	
#	2x NO NEW 50" PORTRAIT MENU BOARDS	
#	NEW 27" PAM SCREEN MOUNTED AT HIGH LEVEL	
#	DUE TO LOW CEILING HEIGHT, ORB POSITION IS TO BE REVIEWED ON SITE BY GALAMAST.	
#	NEW COTF COUNTER, NEW ORB SCREEN MOUNTED AT HIGH LEVEL	
#	EXISTING DOOR TO MANAGERS OFFICE TO BE HANDED AND RELOCATED	
#	FUTURE PROOF FOR NEW DIGITAL HMU	
#	FRANCHISEE HAS REQUESTED A CORNER SOFA	
#	FRANCHISEE HAS REQUESTED A TV CABINET/SIMILAR UNIT	
#	NEW WALL MOUNTED TV SCREEN	
#	REDIRECTION / REDUCTION OR REMOVAL OF VENTILATION DUCTWORK TO BE CONFIRMED WITH CDMP	
#	EXISTING DOOR AND FRAME REMOVED AND MADE GOOD.	
#	WORKS TO CREW ROOM:	
#	Full re-furb throughout to new Crew room decor scheme	
#	New lockers	
#	Crew room to be extended into office space adjacent	
#	New doors throughout	
#	New Kitchen in a cupboard	
#	New Crew recycling bin	
#	New furniture as shown	
#	New wall finishes	
#	New floor finishes	
#	New ceiling finishes	
#	WORKS TO CREW TOILETS & CHANGE:	
#	Full re-furb throughout	
#	Allow for new sanitary ware	
#	New wall finishes	
#	New floor finishes	
#	New ceilings	

DOOR NOTES:
 # Denotes new laminated door with inhomogeneity and signage. Finish of door to match door scheme.
 VP Denotes Fire Panel
 FD Denotes Fire Resistance
 All existing framework to be retained where possible and made good to suit scheme.
 Note: All new doors in existing frames to be measured on site.

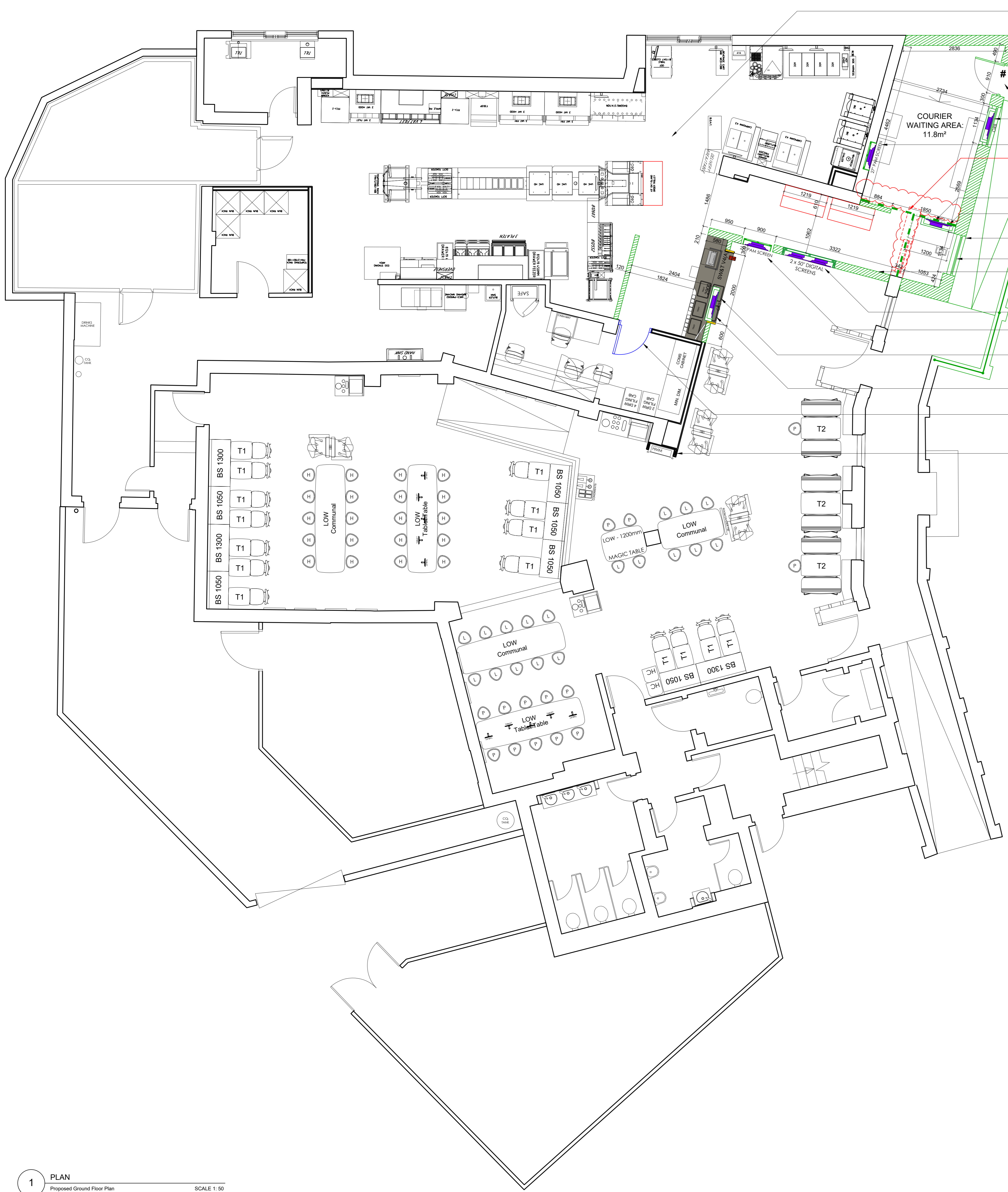

WORKS TO KITCHEN:
 Patch repair hygienic cladding where disturbed by works
 Patch repair and replace floor tiles where disturbed by works
 Patch repair and replace kitchen ceiling tiles where required and extend into courier collect
 Retain existing staff safe
 New external door for courier access
 ORB screen mounted to the window facing out of the building
 New 27" PAM screen mounted at high level
 NEW STEEL STRUCTURE TO SUPPORT THE WALLS AT THE FIRST FLOOR ABOVE TO BE REVIEWED BY A STRUCTURAL ENGINEER
 New ceiling mounted ORB to be installed
 New delivery counter, till and delivery tablet
 New external wall to form extended courier waiting area
 New window with frosted, obscured glass
 New internal walls built to form a new Delivery area & Order Collection area
 2x No new 50" portrait menu boards
 New 27" PAM screen mounted at high level
 DUE TO LOW CEILING HEIGHT, ORB POSITION IS TO BE REVIEWED ON SITE BY GALAMAST.
 New CotF Counter, New ORB screen mounted at high level
 Existing door to managers office to be handed and relocated
 Future proof for new Digital HMU

NOTE: KITCHEN LAYOUT NOT YET PROVIDED FROM H&K. STAGE 2 DRAWINGS SUBMITTED FOR APPROVAL WITHOUT KITCHEN LAYOUT

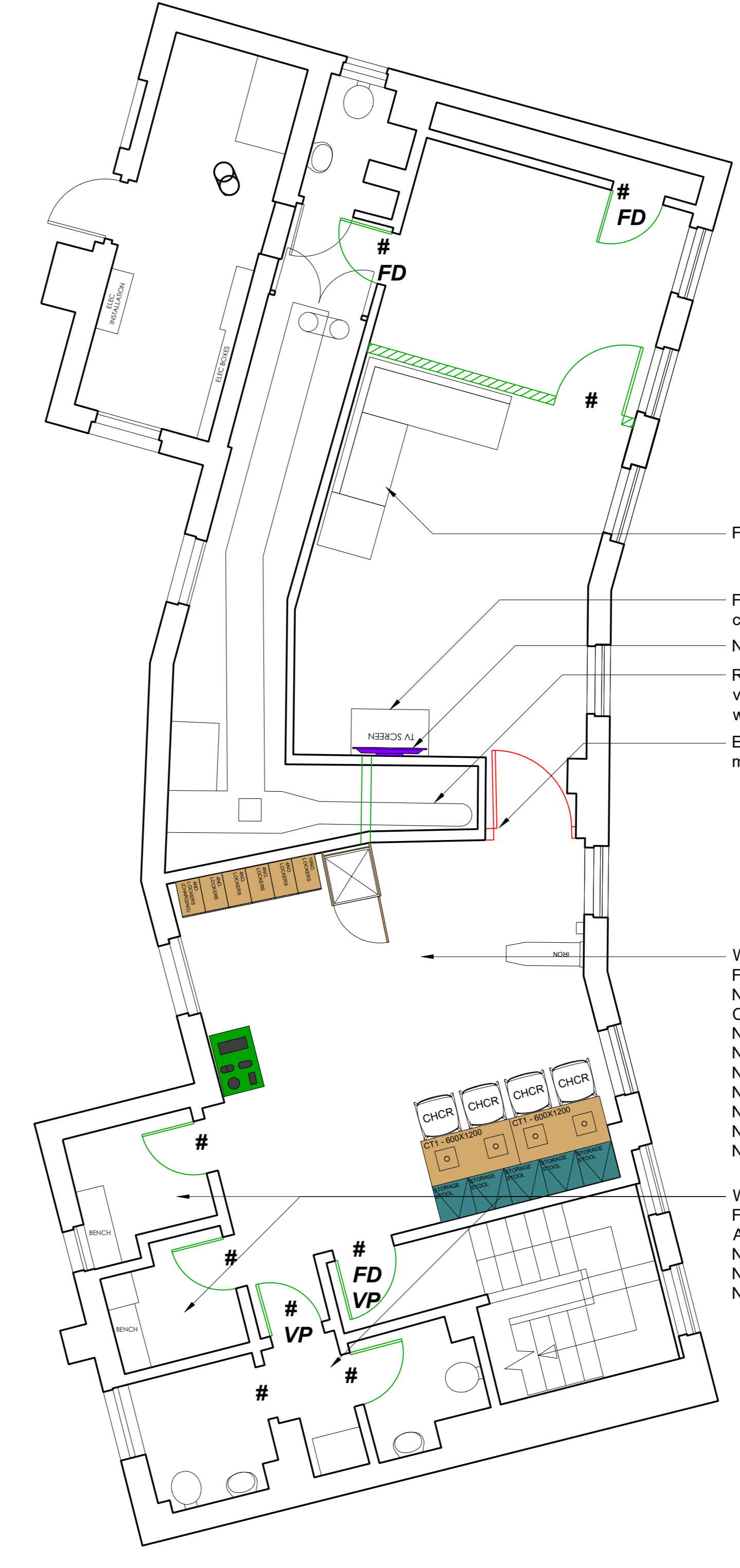

Franchisee has requested a corner sofa
 Franchisee has requested a TV cabinet/similar unit
 New wall mounted TV screen
 Redirection / reduction or removal of ventilation ductwork to be confirmed with CDMP
 Existing door and frame removed and made good.
 WORKS TO CREW ROOM:
 Full re-furb throughout to new Crew room decor scheme
 New lockers
 Crew room to be extended into office space adjacent
 New doors throughout
 New Kitchen in a cupboard
 New Crew recycling bin
 New furniture as shown
 New wall finishes
 New floor finishes
 New ceiling finishes
 WORKS TO CREW TOILETS & CHANGE:
 Full re-furb throughout
 Allow for new sanitary ware
 New wall finishes
 New floor finishes
 New ceilings

2 PLAN
 Proposed First Floor Plan SCALE 1:50

1 PLAN
 Proposed Ground Floor Plan SCALE 1:50

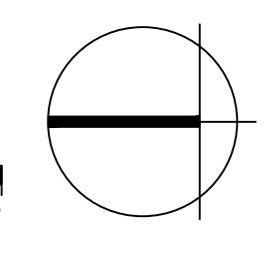
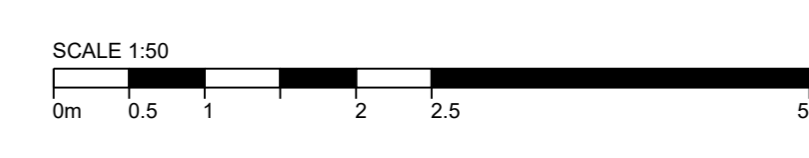

REV	DESCRIPTION	DR / CH	DATE
D	New structural support for the first floor shown. To be reviewed by a structural engineer.	RH / GF	03.03.2022
C	STAGE 2 ISSUE Dimensions added Cleaning notes amended Meeting room dimensioned additional space for the crew meeting	RH / GF	25.02.2022
B	Minor amendments following Stage 1 meeting	GF / GF	15.02.2022
A	Submitted for DWG approval without an updated kitchen layout.	RH / CH	04.01.2022