

THE FOLLOWING SYSTEM DESIGN SPECIFICATION IS FOR THE INSTALLATION OF A FIRE DETECTION AND FIRE ALARM SYSTEM AT THE ABOVE PREMISES. THE FIRE DETECTION AND FIRE ALARM SYSTEM WILL BE DESIGNED, INSTALLED AND COMMISSIONED IN ACCORDANCE WITH BS5839-1: 2017. (A FULL BAFF CERTIFICATE SHALL BE ISSUED WHEN APPROPRIATE).

DESIGN STATEMENT

THE QUOTATION/ SPECIFICATION FOR THE EQUIPMENT AND INSTALLATION ARE PER THE INFORMATION PROVIDED BY THE CLIENT AT THE TIME OF THE SURVEY TO CATCHPOINT UK LTD. THE SYSTEM WILL BE CONTROLLED BY AN ADDRESSABLE CONTROL PANEL, MANUAL CALL POINTS, AUTOMATIC DETECTION, INTERNAL SOUNDERS AND VISUAL ALARM DEVICES.

IT SHALL BE THE CLIENTS RESPONSIBILITY TO VERIFY THAT THE FIRE ALARM PROPOSED WITHIN THIS SPECIFICATION MEETS WITH THE REQUIREMENTS OF ANY INTERESTED PARTY, I.E. INSURERS, BUILDING CONTROL OFFICERS, FIRE AND RESCUE SERVICES ETC.

THE SYSTEM IS DESIGNED FOR A CATEGORY L1 TYPE FIRE DETECTION AND FIRE ALARM SYSTEM

FIRE CABLE
ALL CABLING FOR THE FIRE ALARM SYSTEM WILL BE 2 CORE 1.5MM STANDARD RATED FIRE CABLE.

VARIATIONS FROM DESIGN

PLEASE REFER TO THE VARIATIONS SHEET. STANDARD BATTERY PERIOD THE SYSTEM SHALL BE PROVIDED WITH BATTERIES TO POWER THE SYSTEM FOR A MINIMUM OF 24 HOURS IN STANDBY AND ADDITIONAL 30 MINUTES IN ALARM.

DESIGN DRAWING

THE SYSTEM SHALL BE INSTALLED IN ACCORDANCE WITH THE ATTACHED DRAWING NUMBER: TBC REVISION: 0 DATED: 20/10/2023

CONTROL EQUIPMENT

A 230 VOLT MAIN SUPPLY FOR THE FIRE ALARM IS TO BE SUPPLIED BY OTHERS, IN SOFT SKIN STANDARD FIRE CABLE.

LIST OF EQUIPMENT

- 1 X FIRE PANEL
- 2 X BATTERIES
- 11 X INTERFACES
- 109 X SMOKE DETECTORS (33 X W/SOUNDER BASE, 3 X W/SOUNDER BEACON BASE AND 38 X IN VOID)
- 2 X HEAT DETECTORS (1 X W/SOUNDER BASE)
- 20 X MANUAL CALL POINTS
- 11 X SOUNDER BEACONS (1 X CONVENTIONAL)

FIRE DETAIL KEY	
F.P	ADDRESSABLE FIRE PANEL
F.P.R	FIRE PANEL REPEATER
◀	DIRECTIONAL FIRE EXIT
▲	ILLUMINATED FIRE ESCAPE SIGN
Ⓚ	EMERGENCY LIGHTING
Ⓜ	MANUAL CALL POINT WITH SCI
Ⓜ	EXTERNAL MANUAL CALL POINT SCI
🔊	SOUNDER / VID
🔊	EXTERNAL SOUNDER / VID
🔊	CONVENTIONAL SOUNDER BEACON
🔥	DETECTOR HEAT
🔥	DETECTOR HEAT & SOUNDER BASE WITH SCI
🌫	DETECTOR SMOKE
🌫	DETECTOR SMOKE IN VOID WITH
🌫	DETECTOR SMOKE IN ROOF
🌫	DETECTOR SMOKE & SOUNDER BASE WITH SCI
🌫	DETECTOR SMOKE & SOUNDER VID BEACON BASE WITH SCI
🔊	SOUNDER / HEAT
🔥	SPRINKLER HEAD
🔥	FOAM FIRE EXTINGUISHER
🔥	WATER FIRE EXTINGUISHER
🔥	POWDER FIRE EXTINGUISHER
🔥	CO2 FIRE EXTINGUISHER
👁	BEAM TO BEAM DETECTOR
👁	FIRE BLANKET
👁	BEAM IN VOID
①	INDICATOR
IU	INTERFACE UNIT
IAD	INTERFACE AUTOMATIC DOORS
ISA	INTERFACE SPRINKLER SYSTEM
▶	EXISTING BEAM
FOAM EXTINGUISHERS RATED AT 21A/144B	

Licence for sale of alcohol to cover whole of trading area to allow for flexibility of display - Alcohol display will be less than 10% of trading area.

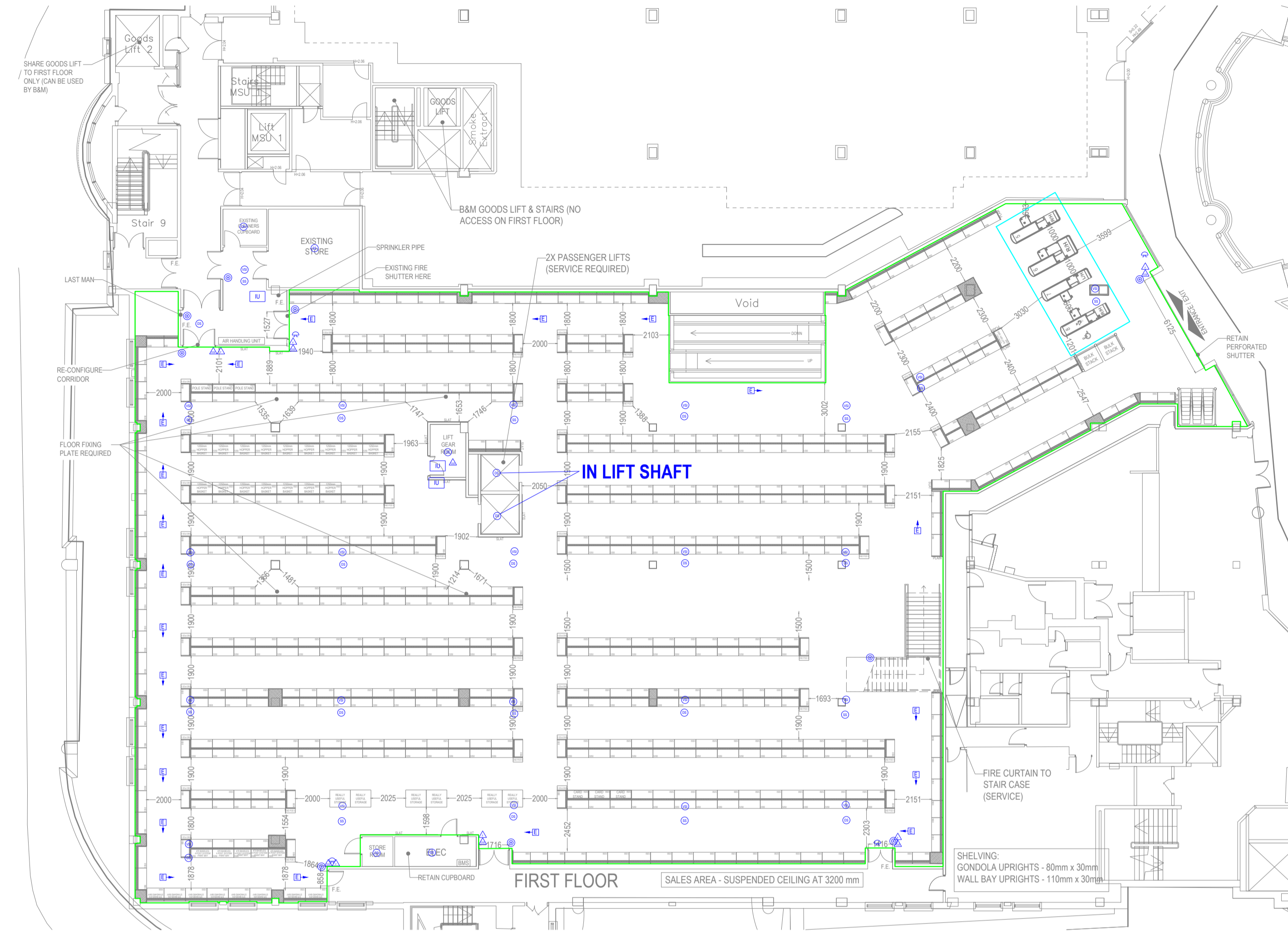

No.	Interface list:	Input / Output
1	Main Entrance Auto Doors GF	Output
2	Escalator 1	Output
3	Escalator 2	Output
4	Fire Curtain	Output
5	Shopping Centre System	Output
6	Ground Floor Fire Shutter	Output
7	Passenger Lift 1	Output
8	Passenger Lift 2	Output
9	Goods Lift	Output
10	Sprinklers	Input
11	Smoke Extract System	Output

PLEASE NOTE:
All auto doors Interfaces must be no more than 1M away from the door

FIRE EXIT PROVISIONS - RETAIL UNIT		EXIT WIDTHS / PERSONS	
			5.0 mm
			18 m
			45 m
			2 m2/PERSONS
Sales Areas			
	Ground Floor	First Floor	
COMPARTMENT AREA (m2)	1,341.9	1,669.1	
OCCUPANCY (PERSONS)	671	835	
REQUIRED OPENING (mm)			
(TOTAL PEOPLE X 5mm PER PERSON EXIT WIDTH)	3,355	4,175	
FIRE EXIT WIDTHS (mm)			
MAIN ENTRANCE/EXIT	6,001	6,125	
MAIN EXIT (IF APPLICABLE)	0	0	
GRP W/H DOORS (IF APPLICABLE)	0	0	
GARDEN CENTRE DOORS (IF APPLICABLE)	0	0	
F/E 1	1,664	1,416	
F/E 2	1,400	1,716	
F/E 3	1,612	858	
F/E 4	0	1,527	
F/E 5	0	0	
TOTAL CLEAR OPENING FROM COMPARTMENT FLOOR AREA (mm)	10,677	11,642	
EXCLUDE LARGEST OPENING (mm)	6,001	6,125	
FINAL CLEAR OPENING (mm)	4,676	5,517	

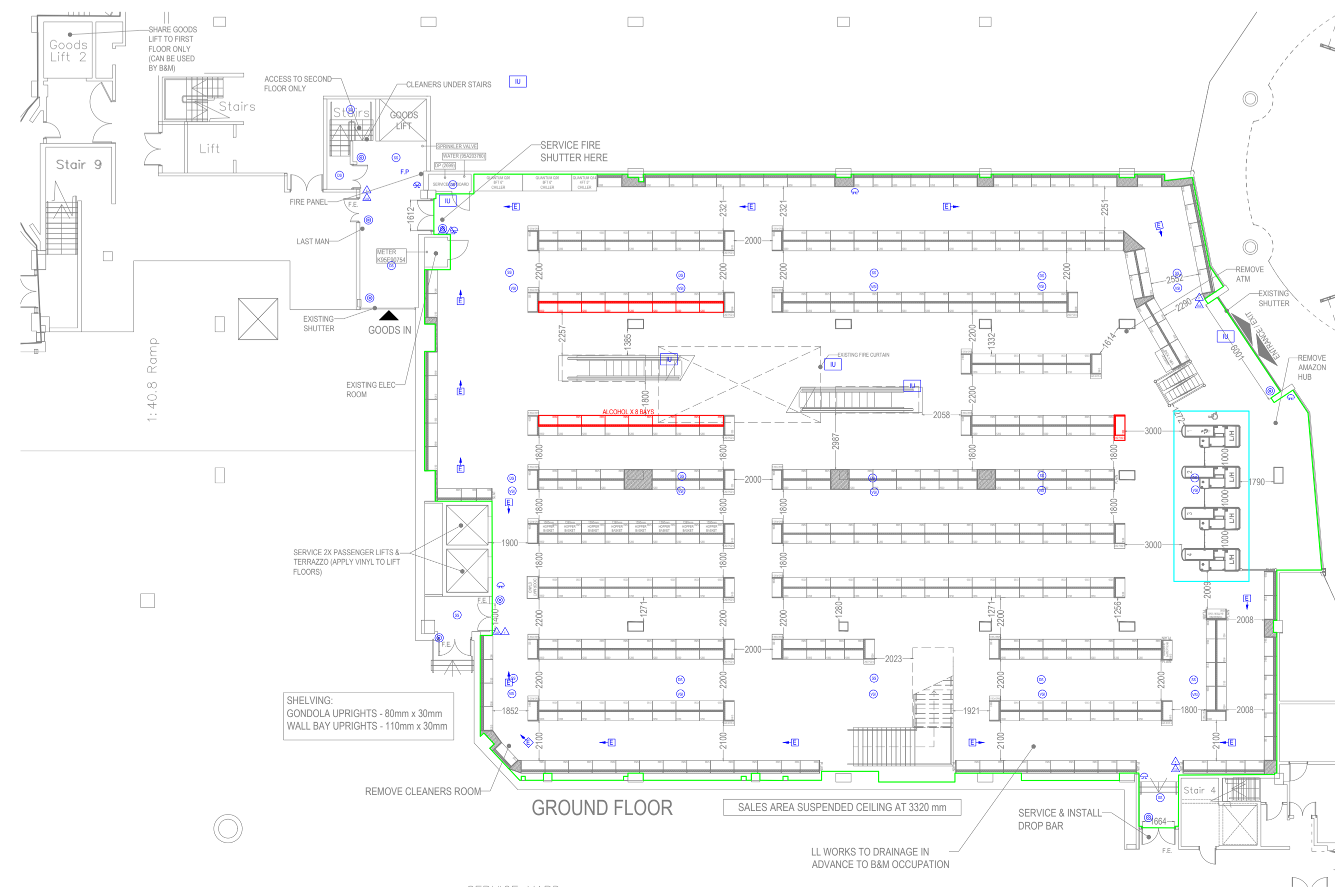

<p>DO NOT SCALE - USE FIGURED DIMENSIONS ONLY. ALL LAYOUTS MUST BE VERIFIED ON SITE AND ANY DISCREPANCIES NOTIFIED IMMEDIATELY TO THE SHOPFITTER. ALL DIMENSIONAL CHECKS MUST BE MADE PRIOR TO INSTALLATION.</p>	<p>HARROW</p> <p>SITE ADDRESS: (FORMER WILKO) MSU 2 ST GEORGES SHOPPING CENTRE ST ANNS ROAD HARROW HA1 1HS</p>	<p>TITLE: PROPOSED FIRE LAYOUT (GROUND FLOOR & FIRST FLOOR)</p> <p>CLIENT: B&M RETAIL LTD.</p>	<p>LAYOUT: BM</p> <p>FLOW: AD</p> <p>DRG No: BM-HRW-0-006</p> <p>DATE: 06.12.23</p>	<p>SCALE: 1:200@A1</p> <p>REVISION: -</p>	<p>SALES AREA</p> <p>WAREHOUSE</p> <p>AMENITIES</p> <p>GARDEN CENTRE (INC. GREENHOUSE)</p> <p>TOTAL GROSS (ALL FLOORS)</p>	<table border="1"> <tr><td>GROUND FLOOR</td><td>1,341.9 sqm</td><td>1,669.1 sqm</td></tr> <tr><td>FIRST FLOOR</td><td>14,444 sqft</td><td>17,966 sqft</td></tr> <tr><td>WALL BAYS</td><td>80</td><td>101</td></tr> <tr><td>GONDOLA BAYS</td><td>338</td><td>476</td></tr> <tr><td>NETT TOTALS</td><td>418</td><td>577</td></tr> <tr><td>TOTAL BAYS (EXCLUDING END BAYS)</td><td colspan="2">1023</td></tr> <tr><td>PROMO END BAYS</td><td>37</td><td>44</td></tr> <tr><td>TOTAL BAYS (INCLUDING END BAYS)</td><td colspan="2">1106</td></tr> </table>	GROUND FLOOR	1,341.9 sqm	1,669.1 sqm	FIRST FLOOR	14,444 sqft	17,966 sqft	WALL BAYS	80	101	GONDOLA BAYS	338	476	NETT TOTALS	418	577	TOTAL BAYS (EXCLUDING END BAYS)	1023		PROMO END BAYS	37	44	TOTAL BAYS (INCLUDING END BAYS)	1106		<table border="1"> <tr><th>STANDARD BAY FOOTAGE</th><th>GROUND FLOOR</th><th>UPPER FLOOR</th><th>GROUND FLOOR</th><th>UPPER FLOOR</th></tr> <tr><td>STANDARD WALL BAYS</td><td>80</td><td>101</td><td>0</td><td>0</td></tr> <tr><td>STANDARD PAINT BAYS</td><td>338</td><td>476</td><td>0</td><td>28</td></tr> <tr><td>STANDARD GONDOLA</td><td>418</td><td>577</td><td>0</td><td>0</td></tr> <tr><td>STANDARD LOW LEVEL</td><td></td><td></td><td></td><td></td></tr> <tr><td>STANDARD GONDOLA</td><td></td><td></td><td></td><td></td></tr> <tr><td>EPV: PROMO ENDS</td><td></td><td></td><td></td><td></td></tr> </table>	STANDARD BAY FOOTAGE	GROUND FLOOR	UPPER FLOOR	GROUND FLOOR	UPPER FLOOR	STANDARD WALL BAYS	80	101	0	0	STANDARD PAINT BAYS	338	476	0	28	STANDARD GONDOLA	418	577	0	0	STANDARD LOW LEVEL					STANDARD GONDOLA					EPV: PROMO ENDS					<table border="1"> <tr><th>SHELVING PROFILES</th><th>HEIGHT</th><th>DEPTH</th></tr> <tr><td>STANDARD WALL BAYS</td><td>H2610</td><td>D470</td></tr> <tr><td>STANDARD PAINT BAYS</td><td>H2610</td><td>D670</td></tr> <tr><td>STANDARD GONDOLA</td><td>H1810</td><td>D470</td></tr> <tr><td>EPV: PROMO ENDS</td><td>H1810</td><td>D470</td></tr> </table> <p>FRONT SHELVING SHALL BE 800MM & 4 FOOT BAYS SYSTEM WITH A 100MM BAY LEIS & 100MM OVERHEAD WITH BEAMER BRACKETS</p> <p>ALL DIMENSIONS SHALL BE SHOWN ON ALL COLUMNS UNLESS OTHERWISE SPECIFIED TO BE INSTALLED AS DETAILED ON DRAWING</p>	SHELVING PROFILES	HEIGHT	DEPTH	STANDARD WALL BAYS	H2610	D470	STANDARD PAINT BAYS	H2610	D670	STANDARD GONDOLA	H1810	D470	EPV: PROMO ENDS	H1810	D470
		GROUND FLOOR	1,341.9 sqm	1,669.1 sqm																																																																														
		FIRST FLOOR	14,444 sqft	17,966 sqft																																																																														
		WALL BAYS	80	101																																																																														
GONDOLA BAYS	338	476																																																																																
NETT TOTALS	418	577																																																																																
TOTAL BAYS (EXCLUDING END BAYS)	1023																																																																																	
PROMO END BAYS	37	44																																																																																
TOTAL BAYS (INCLUDING END BAYS)	1106																																																																																	
STANDARD BAY FOOTAGE	GROUND FLOOR	UPPER FLOOR	GROUND FLOOR	UPPER FLOOR																																																																														
STANDARD WALL BAYS	80	101	0	0																																																																														
STANDARD PAINT BAYS	338	476	0	28																																																																														
STANDARD GONDOLA	418	577	0	0																																																																														
STANDARD LOW LEVEL																																																																																		
STANDARD GONDOLA																																																																																		
EPV: PROMO ENDS																																																																																		
SHELVING PROFILES	HEIGHT	DEPTH																																																																																
STANDARD WALL BAYS	H2610	D470																																																																																
STANDARD PAINT BAYS	H2610	D670																																																																																
STANDARD GONDOLA	H1810	D470																																																																																
EPV: PROMO ENDS	H1810	D470																																																																																

THE FOLLOWING SYSTEM DESIGN SPECIFICATION IS FOR THE INSTALLATION OF A FIRE DETECTION AND FIRE ALARM SYSTEM AT THE ABOVE PREMISES. THE FIRE DETECTION AND FIRE ALARM SYSTEM WILL BE DESIGNED, INSTALLED AND COMMISSIONED IN ACCORDANCE WITH BS5839-1: 2017. (A FULL BAFF CERTIFICATE SHALL BE ISSUED WHEN APPROPRIATE).

DESIGN STATEMENT

THE QUOTATION/ SPECIFICATION FOR THE EQUIPMENT AND INSTALLATION ARE PER THE INFORMATION PROVIDED BY THE CLIENT AT THE TIME OF THE SURVEY TO CATCHPOINT UK LTD. THE SYSTEM WILL BE CONTROLLED BY AN ADDRESSABLE CONTROL PANEL, MANUAL CALL POINTS, AUTOMATIC DETECTION, INTERNAL SOUNDERS AND VISUAL ALARM DEVICES.

IT SHALL BE THE CLIENTS RESPONSIBILITY TO VERIFY THAT THE FIRE ALARM PROPOSED WITHIN THIS SPECIFICATION MEETS WITH THE REQUIREMENTS OF ANY INTERESTED PARTY, I.E. INSURERS, BUILDING CONTROL OFFICERS, FIRE AND RESCUE SERVICES ETC.

THE SYSTEM IS DESIGNED FOR A CATEGORY L1 TYPE FIRE DETECTION AND FIRE ALARM SYSTEM

FIRE CABLE
ALL CABLING FOR THE FIRE ALARM SYSTEM WILL BE 2 CORE 1.5MM STANDARD RATED FIRE CABLE.

VARIATIONS FROM DESIGN

PLEASE REFER TO THE VARIATIONS SHEET. STANDARD BATTERY PERIOD THE SYSTEM SHALL BE PROVIDED WITH BATTERIES TO POWER THE SYSTEM FOR A MINIMUM OF 24 HOURS IN STANDBY AND ADDITIONAL 30 MINUTES IN ALARM.

DESIGN DRAWING

THE SYSTEM SHALL BE INSTALLED IN ACCORDANCE WITH THE ATTACHED DRAWING NUMBER: TBC REVISION: 0 DATED: 20/10/2023

CONTROL EQUIPMENT

A 230 VOLT MAIN SUPPLY FOR THE FIRE ALARM IS TO BE SUPPLIED BY OTHERS, IN SOFT SKIN STANDARD FIRE CABLE.

LIST OF EQUIPMENT

- 1 X FIRE PANEL
- 2 X BATTERIES
- 11 X INTERFACES
- 109 X SMOKE DETECTORS (33 X W/SOUNDER BASE, 3 X W/SOUNDER BEACON BASE AND 38 X IN VOID)
- 2 X HEAT DETECTORS (1 X W/SOUNDER BASE)
- 20 X MANUAL CALL POINTS
- 11 X SOUNDER BEACONS (1 X CONVENTIONAL)

FIRE DETAIL KEY	
F.P	ADDRESSABLE FIRE PANEL
F.P.R	FIRE PANEL REPEATER
E	DIRECTIONAL FIRE EXIT
△	ILLUMINATED FIRE ESCAPE SIGN
⊙	EMERGENCY LIGHTING
⊙	MANUAL CALL POINT WITH SCI
E	EXTERNAL MANUAL CALL POINT SCI
⊙	SOUNDER / VID
⊙	EXTERNAL SOUNDER / VID
⊙	CONVENTIONAL SOUNDER BEACON
⊙	DETECTOR HEAT
⊙	DETECTOR HEAT & SOUNDER BASE WITH SCI
⊙	DETECTOR SMOKE
⊙	DETECTOR SMOKE IN VOID WITH
⊙	DETECTOR SMOKE IN ROOF
⊙	DETECTOR SMOKE & SOUNDER BASE WITH SCI
⊙	DETECTOR SMOKE & SOUNDER VID BEACON BASE WITH SCI
⊙	SOUNDER / HEAT
⊙	SPRINKLER HEAD
△	FOAM FIRE EXTINGUISHER
△	WATER FIRE EXTINGUISHER
△	POWDER FIRE EXTINGUISHER
△	CO2 FIRE EXTINGUISHER
⊙	BEAM TO BEAM DETECTOR
⊙	FIRE BLANKET
⊙	BEAM IN VOID
⊙	INDICATOR
IU	INTERFACE UNIT
IAD	INTERFACE AUTOMATIC DOORS
IS	INTERFACE SPRINKLER SYSTEM
▶	EXISTING BEAM
FOAM EXTINGUISHERS RATED AT 21A/14B	

Licence for sale of alcohol to cover whole of trading area to allow for flexibility of display - Alcohol display will be less than 10% of trading area.

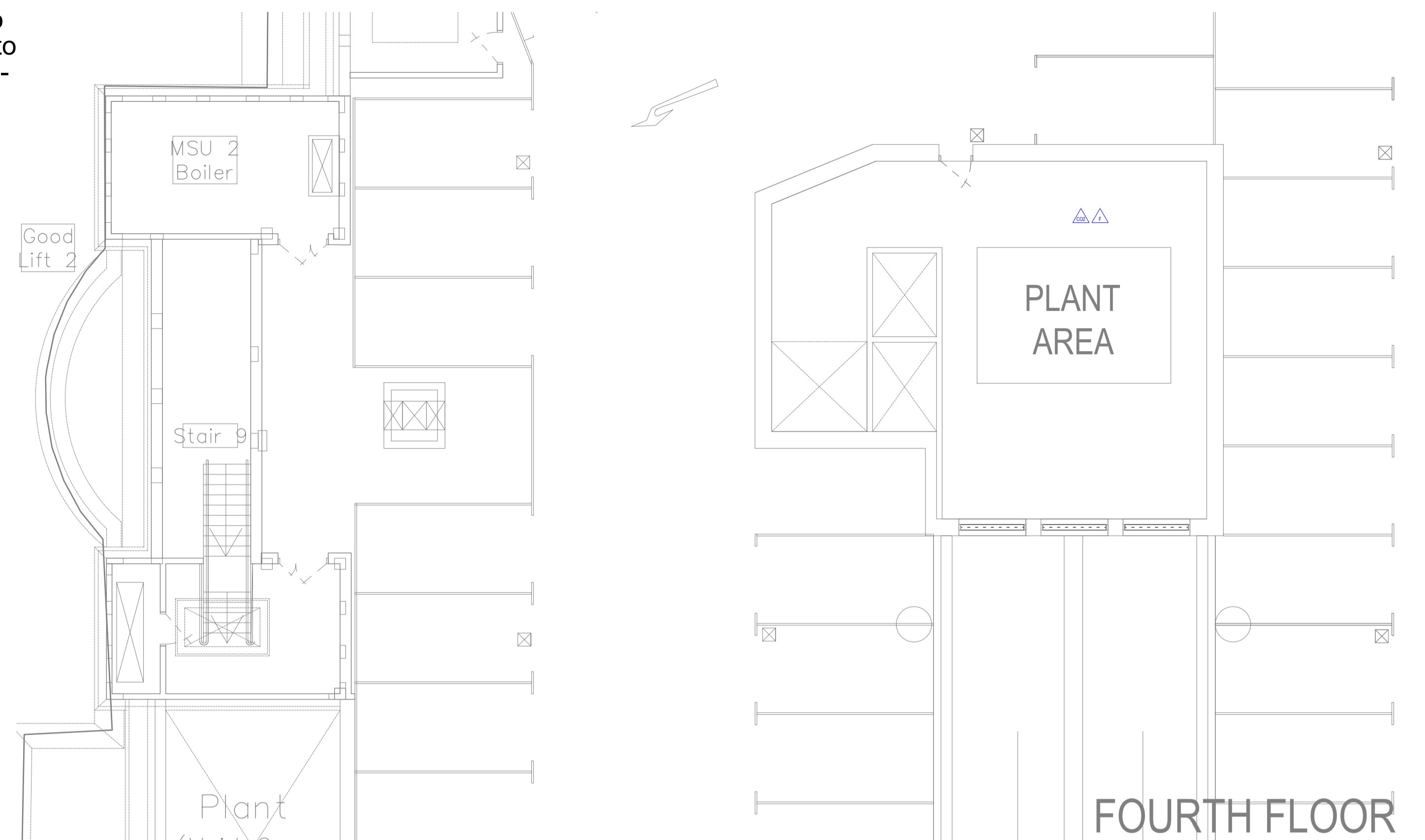

No.	Interface list:	Input / Output
1	Main Entrance Auto Doors GF	Output
2	Escalator 1	Output
3	Escalator 2	Output
4	Fire Curtain	Output
5	Shopping Centre System	Output
6	Ground Floor Fire Shutter	Output
7	Passenger Lift 1	Output
8	Passenger Lift 2	Output
9	Goods Lift	Output
10	Sprinklers	Input
11	Smoke Extract System	Output

PLEASE NOTE:
All auto doors Interfaces must be no more than 1M away from the door

FIRE EXIT PROVISIONS - RETAIL UNIT		5.0 mm
EXIT WIDTHS / PERSONS		18 m
MAX. SINGLE DIRECTIONAL TRAVEL DISTANCE		45 m
MAX. TWO-DIRECTIONAL TRAVEL DISTANCE		2 m2/PERSONS
OCCUPANCY		
Sales Areas		
	Ground Floor	First Floor
COMPARTMENT AREA (m2)	1,341.9	1,669.1
OCCUPANCY (PERSONS)	671	835
REQUIRED OPENING (mm)		
(TOTAL PEOPLE X 5mm PER PERSON EXIT WIDTH)	3,355	4,175
FIRE EXIT WIDTHS (mm)		
MAIN ENTRANCE/EXIT	6,001	6,125
MAIN EXIT (IF APPLICABLE)	0	0
GRP W/H DOORS (IF APPLICABLE)	0	0
GARDEN CENTRE DOORS (IF APPLICABLE)	0	0
F/E 1	1,664	1,416
F/E 2	1,400	1,716
F/E 3	1,612	858
F/E 4	0	1,527
F/E 5	0	0
TOTAL CLEAR OPENING FROM COMPARTMENT FLOOR AREA (mm)	10,677	11,642
EXCLUDE LARGEST OPENING (mm)	6,001	6,125
FINAL CLEAR OPENING (mm)	4,676	5,517

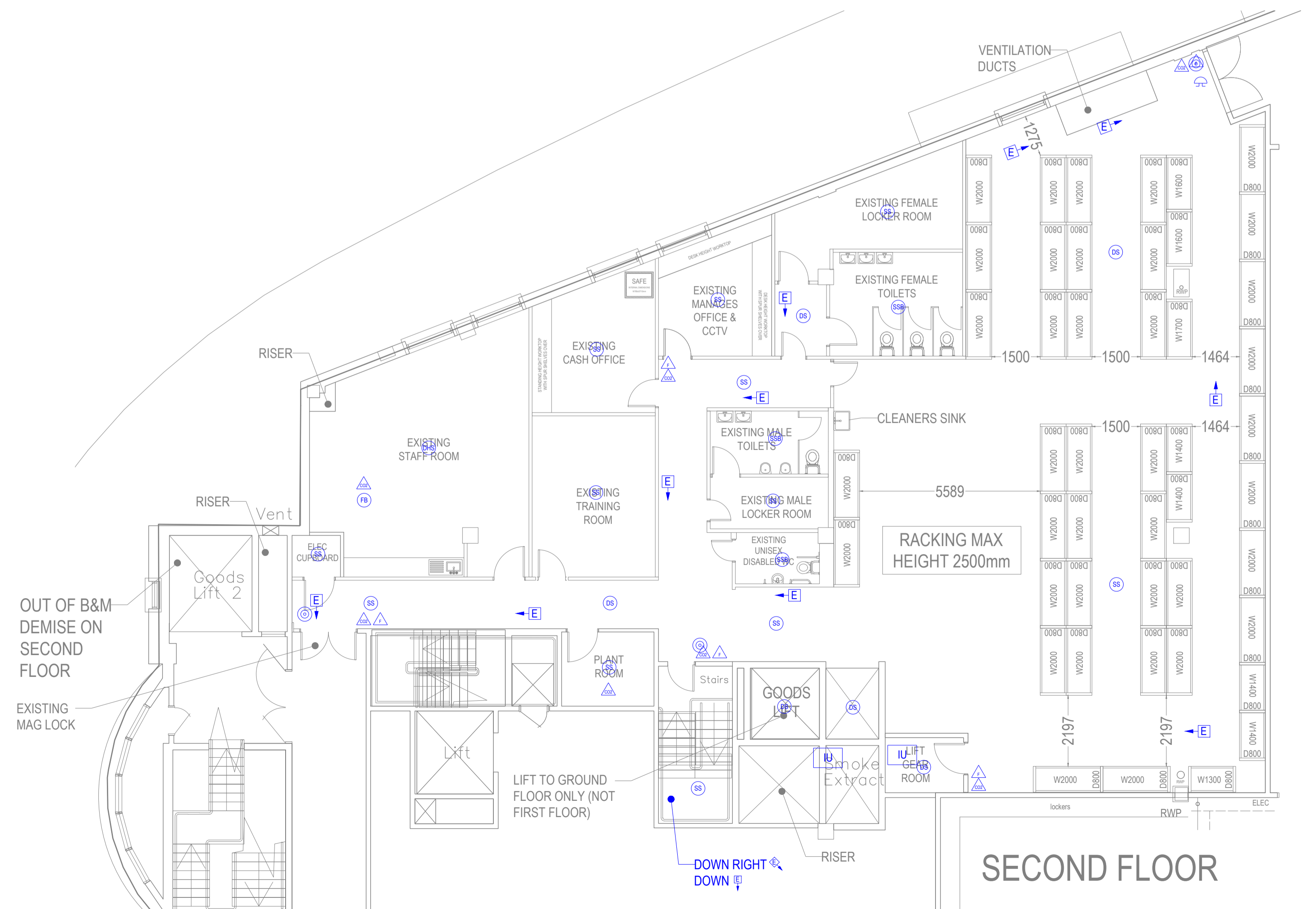

	HARROW		TITLE: PROPOSED FIRE LAYOUT (SECOND FLOOR & FOURTH FLOOR) CLIENT: B&M RETAIL LTD.		
	SITE ADDRESS: (FORMER WILKO) MSU 2 ST GEORGES SHOPPING CENTRE ST ANNS ROAD HARROW HA1 1HS	LAYOUT: BM FLOW: AD	DRG No: BM-HRW-1-006 DATE: 06.12.23	SCALE: 1:100@A1 REVISION: -	REV DATE DESCRIPTION DWN
SALES AREA 1,341.9 sqm 14,444 sqft		WAREHOUSE 0.0 sqm 0.0 sqft		AMENITIES 97.5 sqm 1,049 sqft	
GARDEN CENTRE 0.0 sqm 0.0 sqft		TOTAL GROSS 3,779.3 sqm 40,679 sqft		STANDARD BAY FOOTAGE GROUND FLOOR: 80 UPPER FLOOR: 101 DISPLAY SPACE BAY FOOTAGE GROUND FLOOR: 338 UPPER FLOOR: 476 NETT TOTALS: 418 577 TOTAL BAYS (EXCLUDING END BAYS): 1023 PROMO END BAYS: 37 44 TOTAL BAYS (INCLUDING END BAYS): 1106	
SHELVING PROFILES STANDARD WALL BAYS: H2610 D470 STANDARD PAINT BAYS: H2610 D670 STANDARD LOW LEVEL: H1610 D470 STANDARD GONDOLA: H1610 D470 EPU: PROMO ENDS: H1610 D470		HEIGHT H2610 H2610 H1610 H1610 H1610		DEPTH D470 D670 D470 D470 D470	

DO NOT SCALE - USE FIGURED DIMENSIONS ONLY.
ALL LAYOUTS MUST BE VERIFIED ON SITE AND ANY DISCREPANCIES NOTIFIED IMMEDIATELY TO THE SHOPFITTER. ALL DIMENSIONAL CHECKS MUST BE MADE PRIOR TO INSTALLATION.