

# PAVEMENT LICENCE – LONDON BOROUGH OF HARROW BUSINESS AND PLANNING ACT 2020

<p>Please complete all sections of this form in <b>BLACK</b> ink and return it (with all necessary enclosures) to:  <b>Commercial Licensing, Civic Centre, PO Box 18, Station Road, Harrow HA1 2UT</b></p> <p>Or <a href="mailto:licensing@harrow.gov.uk">licensing@harrow.gov.uk</a></p>	<b>For office use only</b>	
	<b>Fee Received :</b>	
	<b>Receipt Number:</b>	
	<b>Licence Number:</b>	

## Important Notes:

1. If you are completing this form by hand please write legibly in block capitals. In all cases ensure that your answers are inside the boxes and written in black ink. Use additional sheets if necessary. Gridded paper is provided at the back of the application for a plan if required
2. You may wish to keep a copy of the completed form for your records
3. Incomplete applications will not be processed and returned to the applicant

## Section 1: Premises Details

### 1A Address / Location of Premises:

Trading Name of Premises Moon and Sixpence

Address 250 Uxbridge Road, Pinner

.....

.....Post Code HA5 4HS

### 1B Highway Area to be licensed:

Description pavement to the front on Uxbridge Road

.....

## Section 2: Applicant Details

### 2A Applicants Details (correspondence about the licence shall be sent to this person(s)):

Are you:      The Owner of the Premises      Yes / ~~No~~

The Occupier of the Premises      Yes ~~XXX~~

If you are the Occupier, please complete part 2B below, otherwise go to 2C

**2B Owner / Leaseholder Details:**

[Redacted area]

.....  
.....  
.....  
.....  
.....

**A COPY OF THE RELEVANT PART OF THE LEASE SHOWING THE ABOVE AND RIGHT TO OCCUPY THE PREMISE MUST BE SUBMITTED WITH THIS APPLICATION**

**2C Permission**

If the area where furniture is to be placed goes in front of any other premise, please confirm you have their permission and who they are

I can confirm that .....n/a..... Has given permission for the area outside their premise to be used as part of my application<sup>7</sup>

**Section 3: Trading Details**

**3A Date and Hours of Trade:**

Please state the days and times during which the pavement licence will be operational

.....  
Monday      0800 ..... to .....2300.....      Friday      0800 ..... to .....2300.....  
Tuesday      0800 ..... to .....2300.....      Saturday      0800 ..... to .....2300.....  
Wednesday      0800 ..... to .....2300.....      Sunday      0800 ..... to .....2300.....  
Thursday      0800 ..... to .....2300.....

**3B Length of Licence being applied for:**

Please tick the relevant one.

3 months      .....

6 months      .....

1 year      ☒ .....

**Note –no licence can go beyond 30th September 2022**

## Section 4: Furniture Type

### 4A Size and Location of Proposed Area to be covered by Pavement Licence

3m x 11m

.....

.....

.....

### 4B Type being applied for (give numbers)

How many tables / counters / shelves are you applying for? 9.....

How many chairs / benches are you applying for? 32.....

How many picnic table style furniture are you applying for? .....

How many umbrellas are you applying for? 2.....

How many heaters are you applying for? .....

How many barriers are you applying for? .....

**Please provide photos / brochures / information about the proposed type of furniture.**

**Note – you must show on the plan attached to this application where this furniture is to be sited**

### 4C Purpose of the Furniture Proposed

Sell or serve food or drink .....

For use by other people for consumption of food or drink ✓.....

**Note – the food and / or drink must be supplied from, or in connection with, the premise stated in Section 1A. Any other use will not be covered by the pavement licence and be subject to enforcement.**

## Section 5: Enclosures and Disclosure

**For all licence types:**



**A** A completed and signed application form.



**B** Proof of right to occupy the premise, such as a lease, where relevant



**C** Information / photographs / Brochures of furniture being proposed.



**D** Where the proposed activity will take place at a fixed position a map to show all streets in the proximity of the proposed site within at least a radius of 500m of the proposed site should be submitted clearly identifying the proposed location by marking the site boundary with a red line with measurements.



**E** A copy of a valid certificate of insurance covering third party and public liability risks (no less £5million)



**F** The application fee of £50 (please use the green 'Pay for a licence' button on our web page).



**G** A plan showing:

- i. The extent of the perimeter of the premises to which the proposed trading area will be sited. This should include the location of any entry / exit points to/from the premises
- ii. The extent of the trading area, clearly defined and showing the measurements in centimetres
- iii. The location of the proposed furniture and distance / location of any street furniture and edge of pedestrian area
- iv. Plans must be to a scale of either 1:100 or 1:50

**General**

Have you ever been refused a licence in the past? ~~Yes~~ / No

Is yes, please provide details:

.....

.....

Have you ever had a licence revoked? ~~Yes~~ / No

Is yes, please provide details:

.....

.....

Have you ever applied for a tables and chairs licence previously / currently? Yes / ~~No~~



Is yes, please provide details:

A tables and chairs licence has previously been in place for the Village Inn,  
.....

**You must complete and display a public notice (see end of application form) for a period of 5 days 24 hours after submitting the application to the Council. Failure to display will result in an additional 5 day display. Please state end date of consultation stated on your Notice**  
26.08.21

**Declaration**

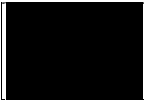
I duly declare that I have checked the information given on this application form and to the best of my knowledge and belief it is correct, and giving false information is an offence. I declare that I have read, understood and agree to all of the terms and conditions outlined in the Pavement Licence and relevant guidance.

Signed:		Date: 19.08.21
		
Print Name		

Applications cannot be accepted unless the correct fee has been paid. Licence fees are not subject to VAT Fees and must be paid for on line at [www.harrow.gov.uk](http://www.harrow.gov.uk) You **MUST** enter the address of the premise the licence is being applied for as the reference. Failure to do this can result in delays.

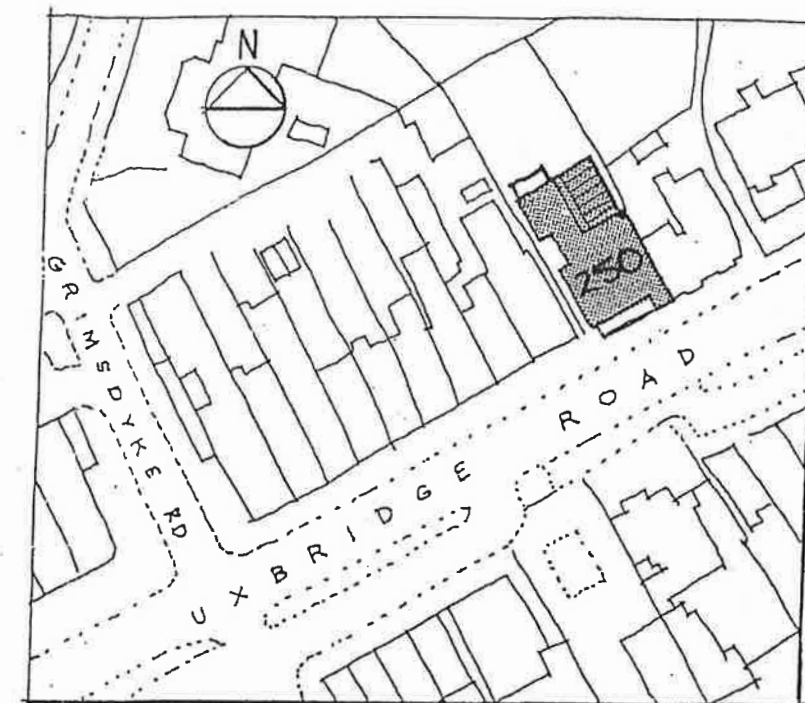
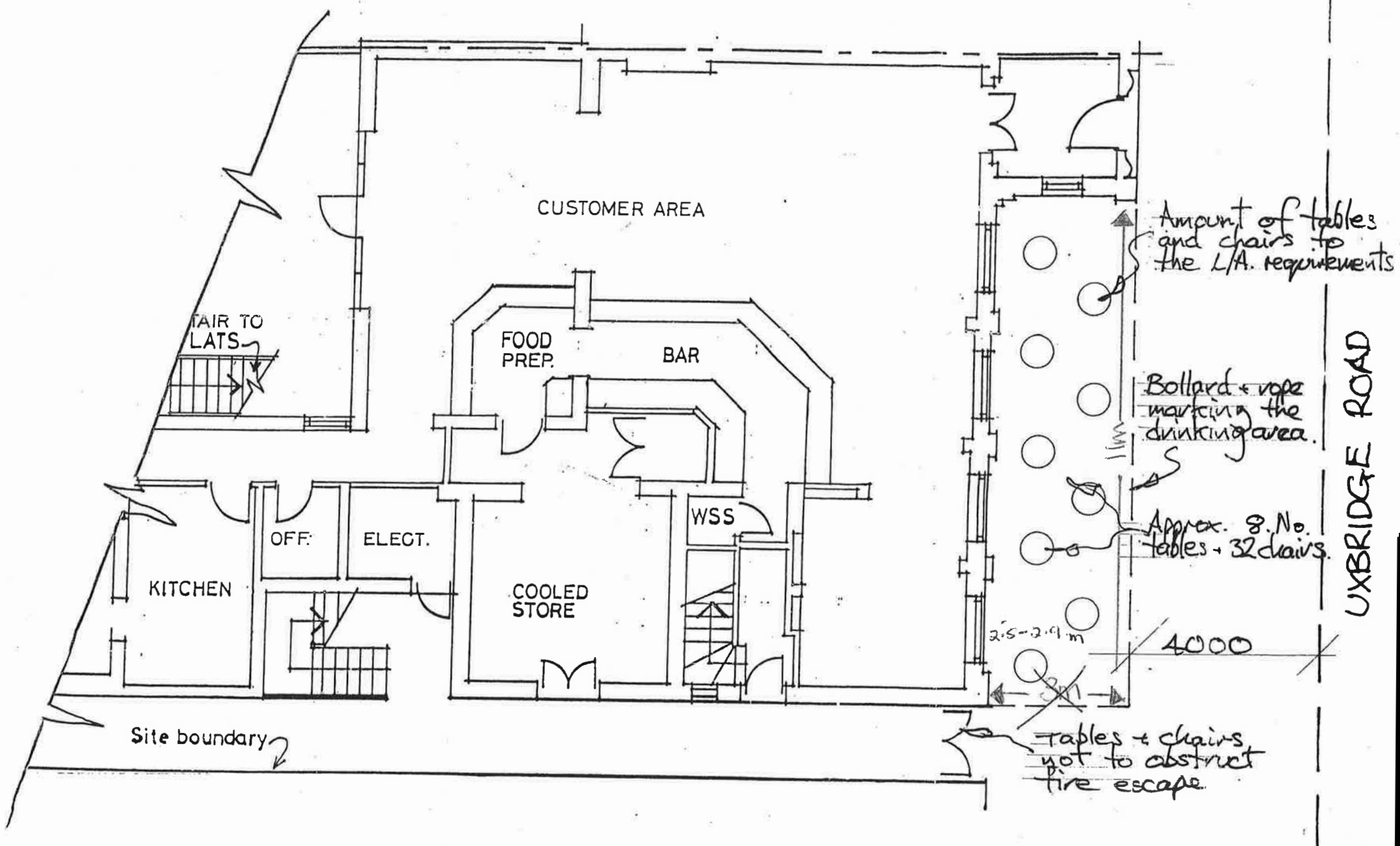

Location plan 1:1250

