

London Borough of Harrow

Proposed Bus Lane and Loading restrictions – High Road, Harrow Weald

The Harrow (Bus Priority) (Amendment No.*) Traffic Order 2020

The Harrow (Waiting and Loading Restriction) (Amendment No.*) Traffic Order 2020

1. NOTICE IS HEREBY GIVEN that the Council of the London Borough of Harrow proposes to make the above mentioned orders under Sections 6, 7, 124 and Part IV of Schedule 9 to the Road Traffic Regulation Act 1984 as amended by the Local Government Act 1985 and all other enabling powers.
2. The general effect of the orders would be extend the existing bus lane in High Road, Harrow Weald, from its junction with Waitrose car park exit, to its junction with Alma Row. The proposed times of operation are the same as those existing, 7am-10am and 4pm-7pm, Monday and Saturday. Existing loading restrictions are proposed to be upgraded in High Road, Harrow Weald, on the east side, to at any time, between the car park exit to the old Homebase, and the car park exit to Waitrose.
3. A copy of the proposed orders and other documents giving more detailed particulars of the orders are available for inspection between 9am and 5pm Monday to Friday at the Civic Centre, until the expiration of a period of 21 days from the date on which this notice is published. Further information can be obtained by telephoning the Project Officer, Tushar Patel on 020 8424 7534, or by visiting the traffic order page at www.harrow.gov.uk/trafficorders or by QR code on this notice.
4. All objections and other representations relating to the proposed orders must be made in writing and received at the address given below quoting reference DP2020-04 not later than 25th March 2020. All objections must specify the grounds on which they are made. Email: transportation@harrow.gov.uk.

Dated 5th March 2020

David Eaglesham, Head of Traffic, Highways and Asset Management,

Community Directorate, PO Box 39, Civic Centre, Station Road, Harrow, HA1 2XA



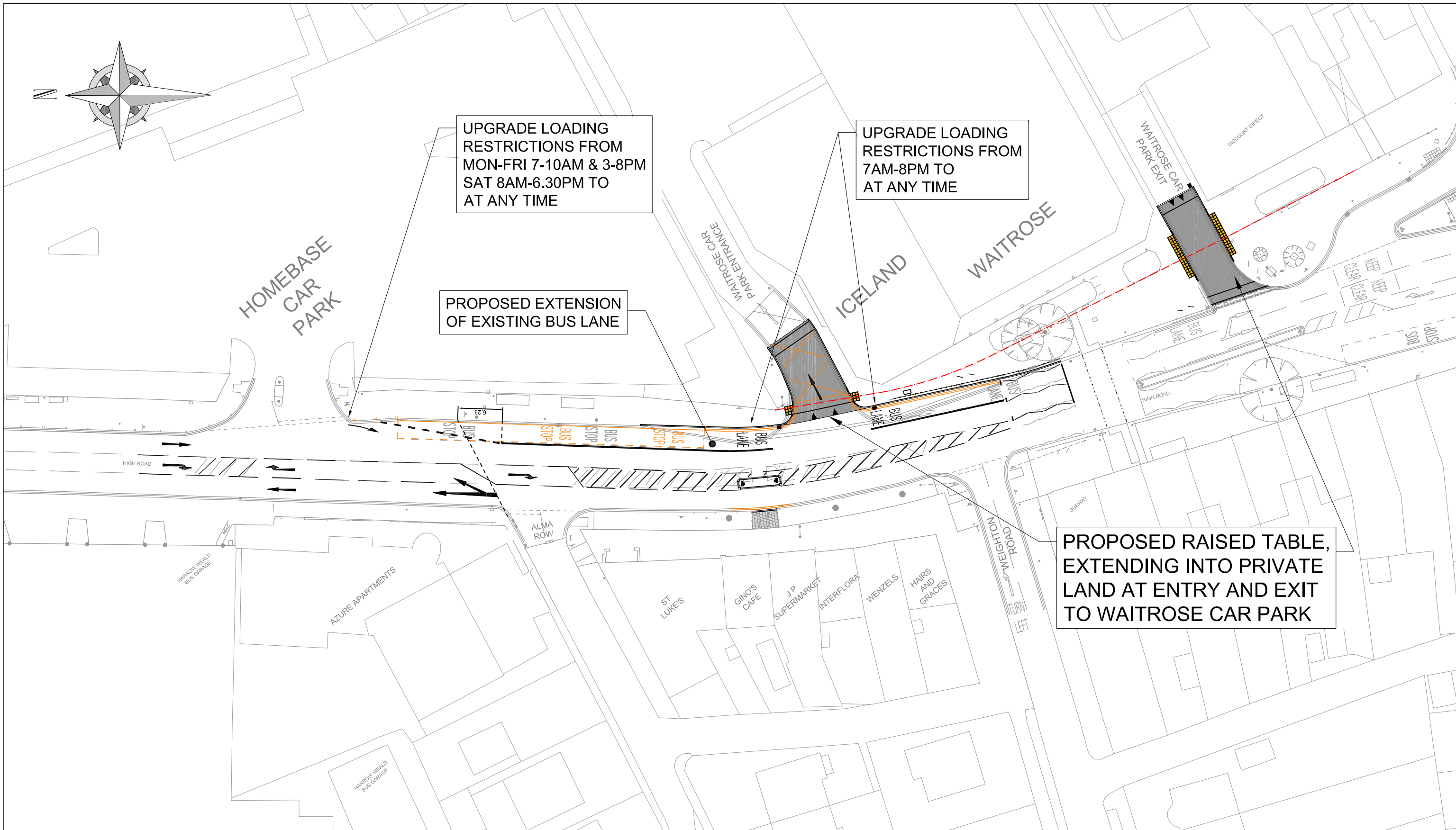
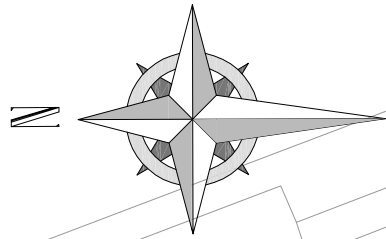

UPGRADE LOADING RESTRICTIONS FROM MON-FRI 7-10AM & 3-8PM SAT 8AM-6.30PM TO AT ANY TIME

UPGRADE LOADING RESTRICTIONS FROM 7AM-8PM TO AT ANY TIME

PROPOSED EXTENSION OF EXISTING BUS LANE

PROPOSED RAISED TABLE, EXTENDING INTO PRIVATE LAND AT ENTRY AND EXIT TO WAITROSE CAR PARK

| | | | | | |
|----------|---------------|-------------------|----------------------|---------------------|----------------------|
| - | INITIAL ISSUE | - | - | - | - |
| REVISION | AMENDMENT | DRAWN BY AND DATE | DESIGNED BY AND DATE | CHECKED BY AND DATE | APPROVED BY AND DATE |



| | |
|---------------|---|
| DEPARTMENT | TRAFFIC AND HIGHWAY NETWORK MANAGEMENT TEAM |
| PROJECT | TPR0158 : HIGH ROAD, HARROW WEALD |
| DRAWING TITLE | TMO PLAN STATUTORY CONSULTATION |

| | | | | |
|-------|-----------------------------|--------------------------------|-------------------------------------|---------------|
| DRAFT | SCALE (AT A3 SIZE) 1:500 | ISSUING OFFICE TRAFFIC TEAM | DRAWING NUMBER TDWG00158-HIGH RD | REVISION A |
| ISSUE | ✓ | TELEPHONE 020 8424 7534 | | |

Reproduction from the Ordnance Survey Mapping with the permission of the Controller of Her Majesty's Stationary Office © Crown Copyright. Unauthorized reproduction infringes Crown Copyright and may lead to prosecution or civil proceedings. London Borough of Harrow 100019206.