

FIRE SAFETY LEGEND	
	ILLUMINATED FIRE EXIT SIGN
	EMERGENCY LIGHT
	HEAT DETECTOR
	SMOKE DETECTOR
	MINIMUM 30MIN FIRE RESISTANT DOORS
	RUNNING MAIN FIRE EXIT SIGN
	CARBON DIOXIDE FIRE EXTINGUISHER
	WATER FIRE EXTINGUISHER
	MECHANICAL EXTRACTOR MIN 15L/S
	WINDOW FAN

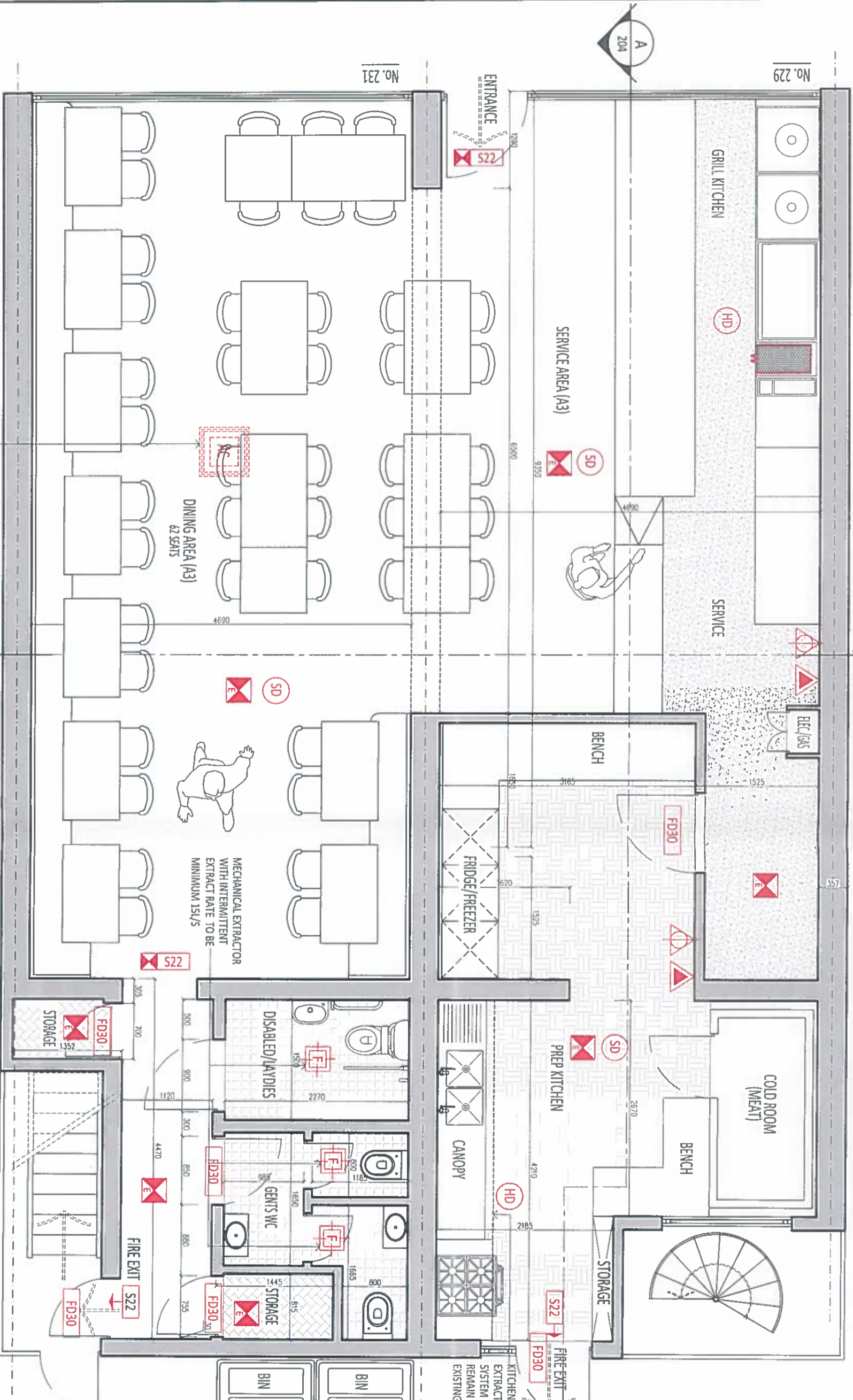

NOTE:

- ADJUSTMENT OF FIXED MECHANICAL VENTILATION AND ASSOCIATED CONTROL TO BE TESTED BY SPECIALIST
- ELECTRICAL WORKS TO BE DONE BY A PERSON COMPETENT TO DO SO AND ELECTRICAL CERTIFICATE TO BE OBTAINED UPON COMPLETION.
- ALL NEW DOORS AND WINDOWS TO ACHIEVE U-VALUE OF 0.16 W/M²K.
- ANY GLAZED DOORS SHALL BE PROVIDED WITH MAINFESTATION WHERE THEY ARE IN ZONES OF IMPACT. DOORS FOR MEANS OF ESCAPE TO BE DEADLOCKED WITH PUSH BAR.

NOTE:

- HEATING/HOT WATER SYSTEM TO BE IN COMPLIANCE WITH DOMESTIC HEATING GUIDE.
- HOT WATER FAUCETS SHALL BE PROVIDED WITH FITTINGS PREVENTING VERY HOT SCALDING WATER FROM BEING DISCHARGED.
- WASTE PIPES: 1/1/1C 100MM, HWB 40MM, SANITARY PIPENWORK AND DRAINAGE MUST COMPLY WITH THE RELEVANT CLAUSES IN SECTION 1 AND 3 OF APPROVAL DOCUMENT H OR BS EN12056-2:2000. GRAVITY DRAINAGE SYSTEMS INSIDE BUILDINGS, AND RELEVANT PARTS OF BS EN152, DRAINS AND SEWER SYSTEMS OUTSIDE BUILDING

FIXED INTERNAL LIGHTING
TO ANY NEW WIRING SYSTEM OR WHEN RE-WIRING AN EXISTING LIGHTING SYSTEM FIT ENERGY EFFICIENT LIGHT FITTINGS AS FOLLOWS:
INSTALL NOT LESS THAN 3 PER 4 ALL THE LIGHT FITTINGS IN THE MAIN DWELLING SPACES (EXCLUDING INFREQUENTLY ACCESSED STORAGE SPACES AND CLOSET/ROBES). LOW ENERGY LIGHT FITTINGS THAT ONLY TAKE LAMPS HAVING A LUMINOUS EFFICACY GREATER THAN 400 LAMP LUMENS.
LIGHT FITTINGS WITH SUPPLIED POWER LESS THAN 5 CIRCUIT-WATTS ARE EXCLUDED FROM THE OVERALL COUNT OF TOTAL LIGHT FITTINGS.

01 PROPOSED FLOOR PLAN

1:50 @ A3

205

B

204

A

205

B

204

A

205

B

204

A

205

B

204

A

205

B

204

A

205

B

204

A

205

B

204

A

205

B

204

A

205

B

204

A

205

B

204

A

205

B

204

A

205

B

204

A

205

B

204

A

205

B

204

A

205

B

204

A

205

B

204

A

205

B

204

A

205

B

204

A

205

B

204

A

205

B

204

A

205

B

204

A

205

B

204

A

205

B

204

A

205

B

204

A

205

B

204

A

205

B

204

A

205

B

204

A

205

B

204

A

205

B

204

A

205

B

204

A

205

B

204

A

205

B

204

A

205

B

204

A

205

B

204

A

205

B

204

A

205

B

204

A

205

B

204

A

205

B

204

A

205

B

204

A

205

B

204

A

205

B

204

A

205

B

204

A

205

B

204

A

205

B

204

A

205

B

204

A

205

B

204

A

205

B

204

A

205

B

204

A

205

B

204

A

205

B

204

A

205

B

204

A

205

B

204

A

205

B

204

A

205

B

204

A

205

B

204

A

205

B

204

A

205

B

204

A

205

B

204

A

205

B

204

A

205

B

204

A

205

B

204

A

205

B

204

A

205

B

204

A

205

B

204

A

205

B

204

A

205

B

204

A

205

B

204

A

205

B

204

A

205

B

204

A

205

B

204

A

205

B

204

A

205

B

204

A

205

B