

Note:
All drawings to be read in conjunction with all other drawings as noted on issue sheet.
Extent of Site Boundary indicated thus: [Symbol]
Signage: All proposed signs noted on drawing including illuminated and method of illumination. Refer to drawing 11 for setting out positions.
See diag 15 for Signage Details
See diag 10 for Patio Details
See diag 12 for Ducts & Services Details

Schedule of Areas	
Existing Site Area	0.3303 ha
Existing Building (GFA / m ²) (Excluding Corral, Freezer/Chiller)	406m ²
Proposed Site Area	0.3303 ha
Proposed Building (GFA / m ²) (Excluding Corral, Freezer/Chiller)	406m ²
Proposed Building (GFA / m ²)	102m ²

Schedule of Parking	
Existing Grill Bays	2 Bays
Existing Accessible Bays	2 Bays
Existing General Bays	46 Bays
Existing Total Bays	50 Bays
Proposed Grill Bays	2 Bays
Proposed Accessible Bays	2 Bays
Proposed General Bays	43 Bays
Proposed Total Bays	47 Bays

KEY - Proposed External	
[Green Box]	Existing Relocated
[Blue Box]	New Surface As Indicated
[Light Blue Box]	New Concrete Surface
[Hatched Box]	New Paving
[Dark Blue Box]	New Extension
[Blue Line]	New Fence

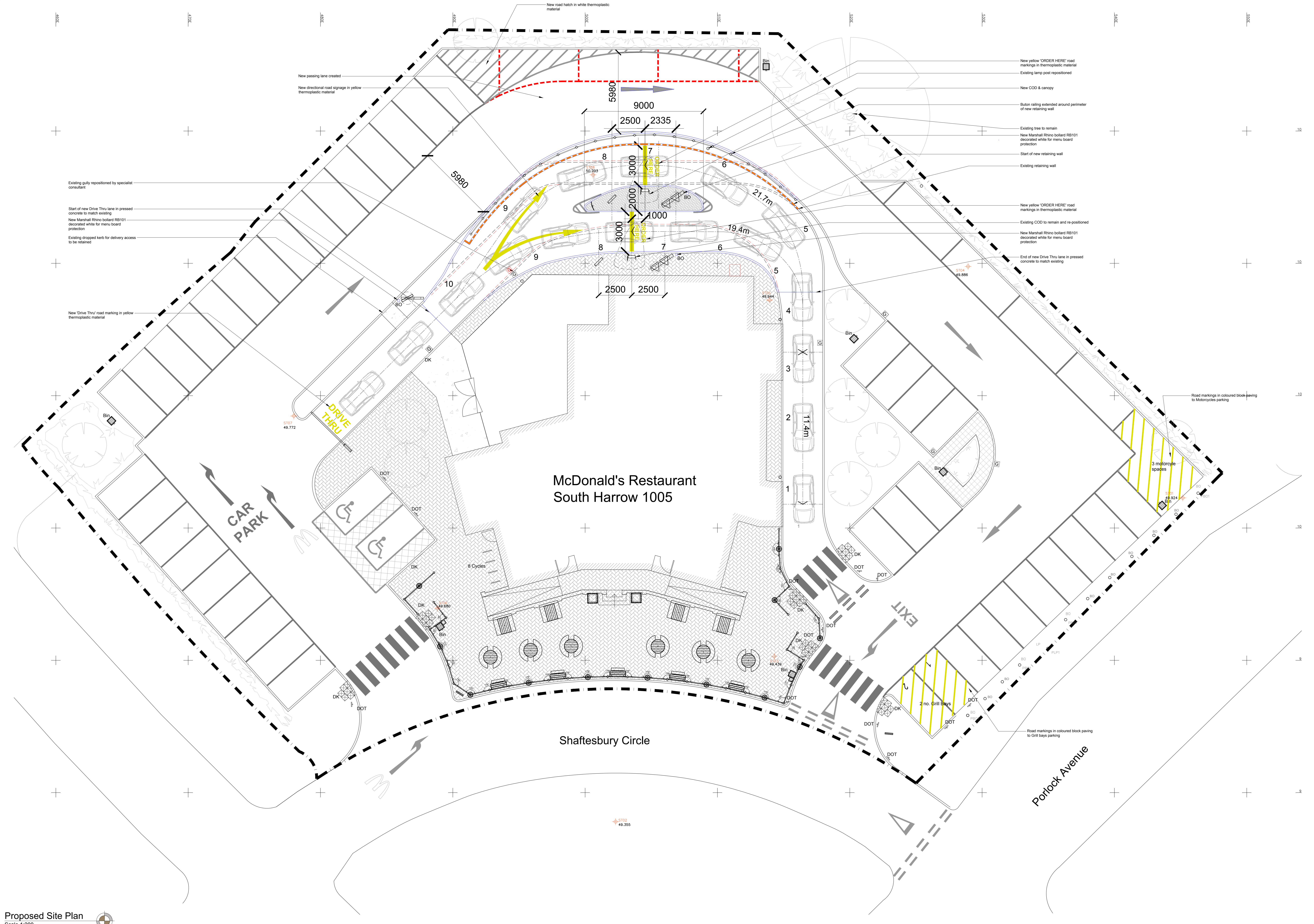
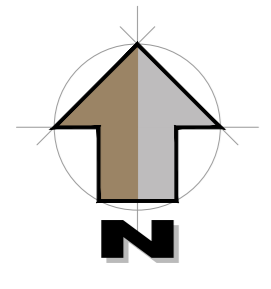

McDonald's Restaurant
South Harrow 1005

Shaftesbury Circle

Portlock Avenue

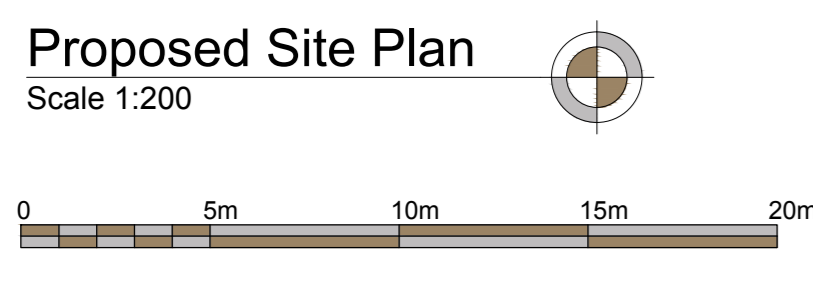

ERDDS
SALOON

Rev	Date	Description	By	Check
0	01.05.15	Issue for planning	JE	JE
1	01.05.15	Issue for planning	JE	JE
2	01.05.15	Issue for planning	JE	JE
3	01.05.15	Issue for planning	JE	JE

This drawing has been reviewed and signed off by McDonald's Restaurants Quality Service. Changes of development should be reported to the relevant project manager and designers prior to commencing work on site. Name: [Name] Date: [Date]

GENERAL NOTES:
All works are to be undertaken in accordance with the Building Regulations and the latest British Standards.
All proposed materials and products are to be used exactly as specified with the manufacturer's recommendations.
All dimensions to be checked on site prior to construction.

McDonald's Restaurants Ltd
1005

Proposed Site Plan
(Scale by 20k Option)