

EXISTING PLAN

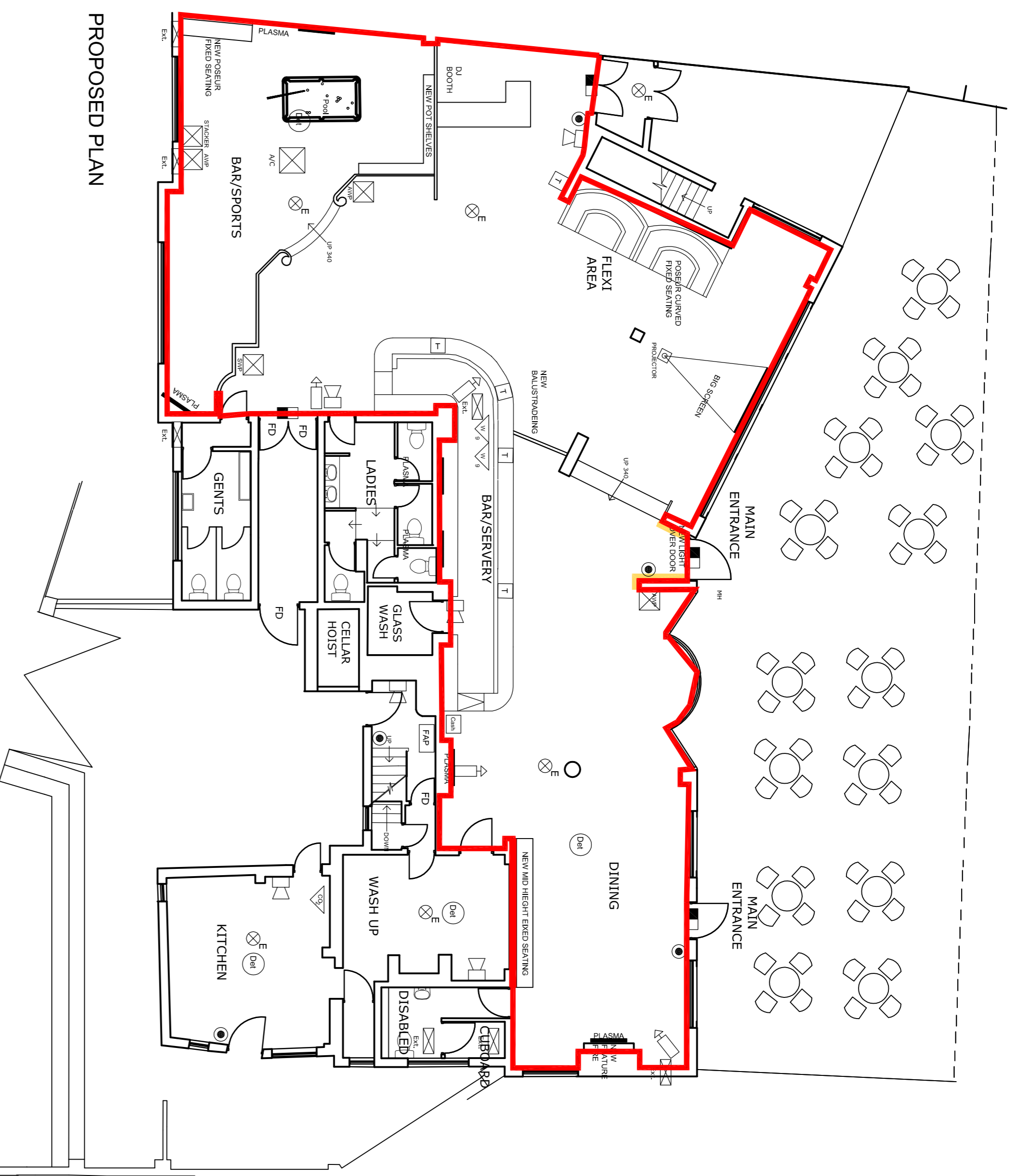

PROPOSED PLAN

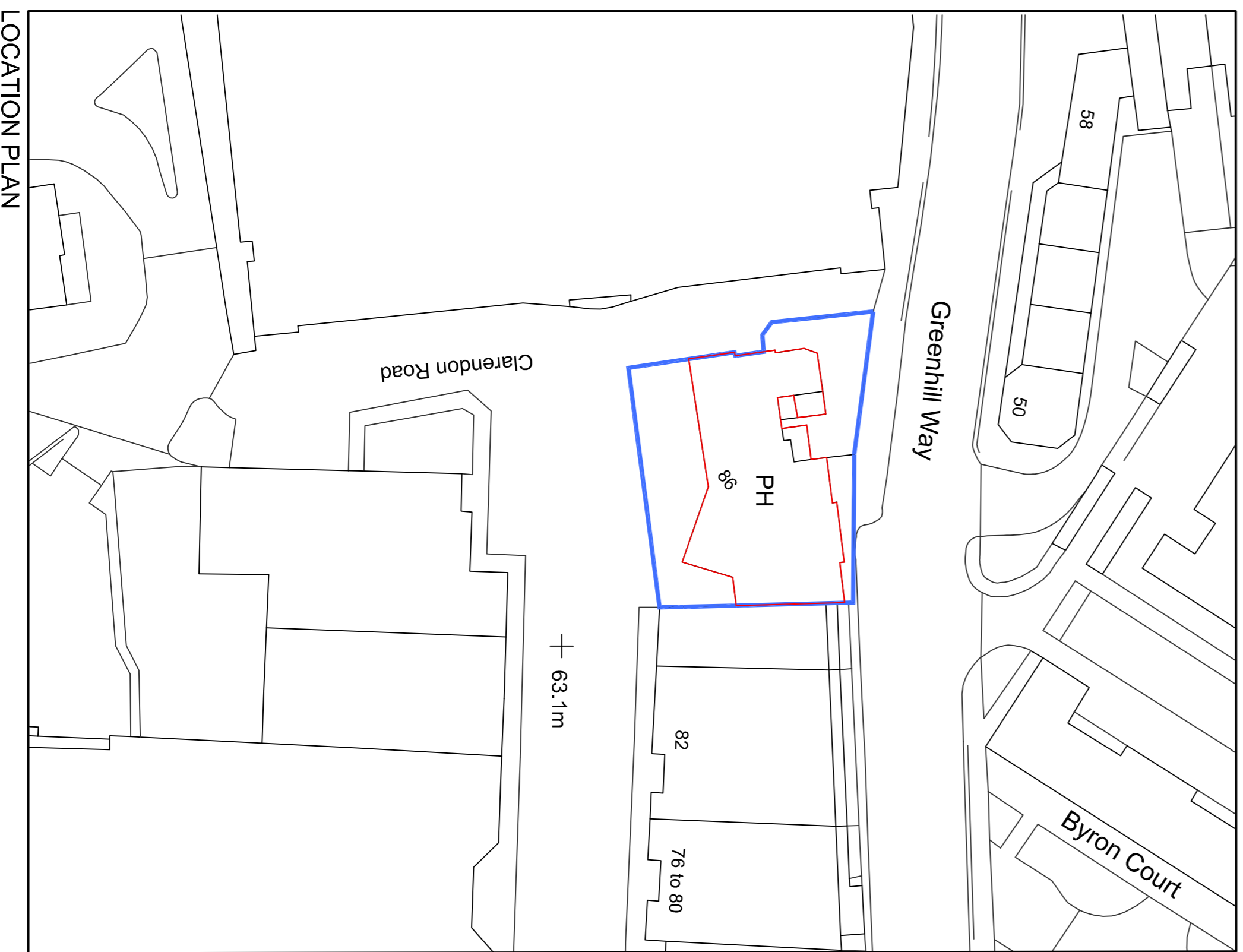

LOCATION PLAN

- LEGEND**
- FD Fire Rated Doorset
  - Fire Rated Doorset
  - Fixtures and Fittings
  - Pool Table
  - AWP/SWP Positions Indicated.
  - Services
  - Fire Alarm Panel
  - Automatic fire detector
  - Manual Call Point
  - Sounder
  - Sounder Beacon
  - Smoke / Heat detectors
  - Emergency / Light-fitting (Fluorescent Downlight or Luminaire)
  - Emergency Exit Light (C/W legend (directional))
  - 9-litre water fire extinguisher
  - Dry powder fire extinguisher
  - Carbon Dioxide fire extinguisher
  - Foam fire extinguisher
  - CCTV camera
  - Mechanical extraction fan
  - Air-conditioning unit
  - Emergency Lighting (Emergency fire and sign with Euro style sign, edge lit)
  - Emergency lighting to be in accordance with BS 5266 part 1 and comply with the appropriate edition requirements. Test and certify as required.
  - Fire safety signage to be in accordance with BS 5499.
- AREA OF LICENSABLE ACTIVITIES**
- BOUNDARY LINE**

**NOTES**

- This drawing is intended to be used for the purpose of the application for a licence to sell alcohol for consumption on the premises. It is not intended to be used for any other purpose.
- The design of the premises must be in accordance with the relevant fire safety regulations and standards.
- The design of the premises must be in accordance with the relevant health and safety regulations and standards.
- The design of the premises must be in accordance with the relevant accessibility regulations and standards.
- The design of the premises must be in accordance with the relevant environmental regulations and standards.
- The design of the premises must be in accordance with the relevant planning regulations and standards.
- The design of the premises must be in accordance with the relevant building regulations and standards.
- The design of the premises must be in accordance with the relevant electrical regulations and standards.
- The design of the premises must be in accordance with the relevant gas regulations and standards.
- The design of the premises must be in accordance with the relevant water regulations and standards.
- The design of the premises must be in accordance with the relevant drainage regulations and standards.
- The design of the premises must be in accordance with the relevant ventilation regulations and standards.
- The design of the premises must be in accordance with the relevant noise regulations and standards.
- The design of the premises must be in accordance with the relevant air quality regulations and standards.
- The design of the premises must be in accordance with the relevant energy regulations and standards.
- The design of the premises must be in accordance with the relevant sustainability regulations and standards.
- The design of the premises must be in accordance with the relevant social responsibility regulations and standards.
- The design of the premises must be in accordance with the relevant ethical regulations and standards.
- The design of the premises must be in accordance with the relevant human rights regulations and standards.
- The design of the premises must be in accordance with the relevant equality regulations and standards.
- The design of the premises must be in accordance with the relevant diversity regulations and standards.
- The design of the premises must be in accordance with the relevant inclusion regulations and standards.
- The design of the premises must be in accordance with the relevant community regulations and standards.
- The design of the premises must be in accordance with the relevant social justice regulations and standards.
- The design of the premises must be in accordance with the relevant human dignity regulations and standards.
- The design of the premises must be in accordance with the relevant human rights regulations and standards.
- The design of the premises must be in accordance with the relevant equality regulations and standards.
- The design of the premises must be in accordance with the relevant diversity regulations and standards.
- The design of the premises must be in accordance with the relevant inclusion regulations and standards.
- The design of the premises must be in accordance with the relevant community regulations and standards.
- The design of the premises must be in accordance with the relevant social justice regulations and standards.
- The design of the premises must be in accordance with the relevant human dignity regulations and standards.

Client:	SPIRIT GROUP BARRAS		
Project:	THE ROYAL OAK HARROW		
Title:	LICENSING		
Scale:	1:100 @A1	Drawn:	TML
Drawing no:	0064/12/10/01	Date:	17/12/12
		Checked:	
<p>The White House, 24a St Andrews Road, Sheffield, S11 9AL          T: 0114 226 0255 F: 0114 226 0256          E: office@whitedesign.co.uk W: www.whitedesign.co.uk</p>			