

Key:

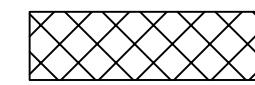

Parking area for
Permit Holders
only

This map is reproduced from or based upon rvey material with the permission of Ordnance Survey on behalf of the Controller of Her Majesty's Stationary Office (c) Crown copyright. Unauthorised reproduction infringes Crown Copyright and may lead to prosecution or civil proceedings. London Borough of Harrow 100019206.



COMMUNITY & ENVIRONMENT
TRANSPORTATION
P.O. Box 39, Civic Centre,
Harrow, Middlesex. HA1 2XA
Tel: 020 8863 5611
Fax: 020 8420 9611

--	-----	-/-/-	--
----	-------	-------	----

Designation	Details of Revision	Date	Sign
-------------	---------------------	------	------

Project
HOUSING PARKING CONTROLS

Title
**BARONS MEAD
PROPOSED PERMIT HOLDERS
ONLY AREA**

Scale	Drawn	Checked
1:200	RLM	
@ A3	Date	PN
	14/09/12	

Drawing no
T/DWG/000376b

Autocad file

Key:

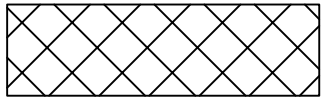

Parking area for
Permit Holders or
Pay & Display

27
29

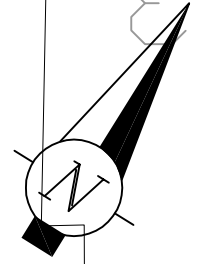

Hall

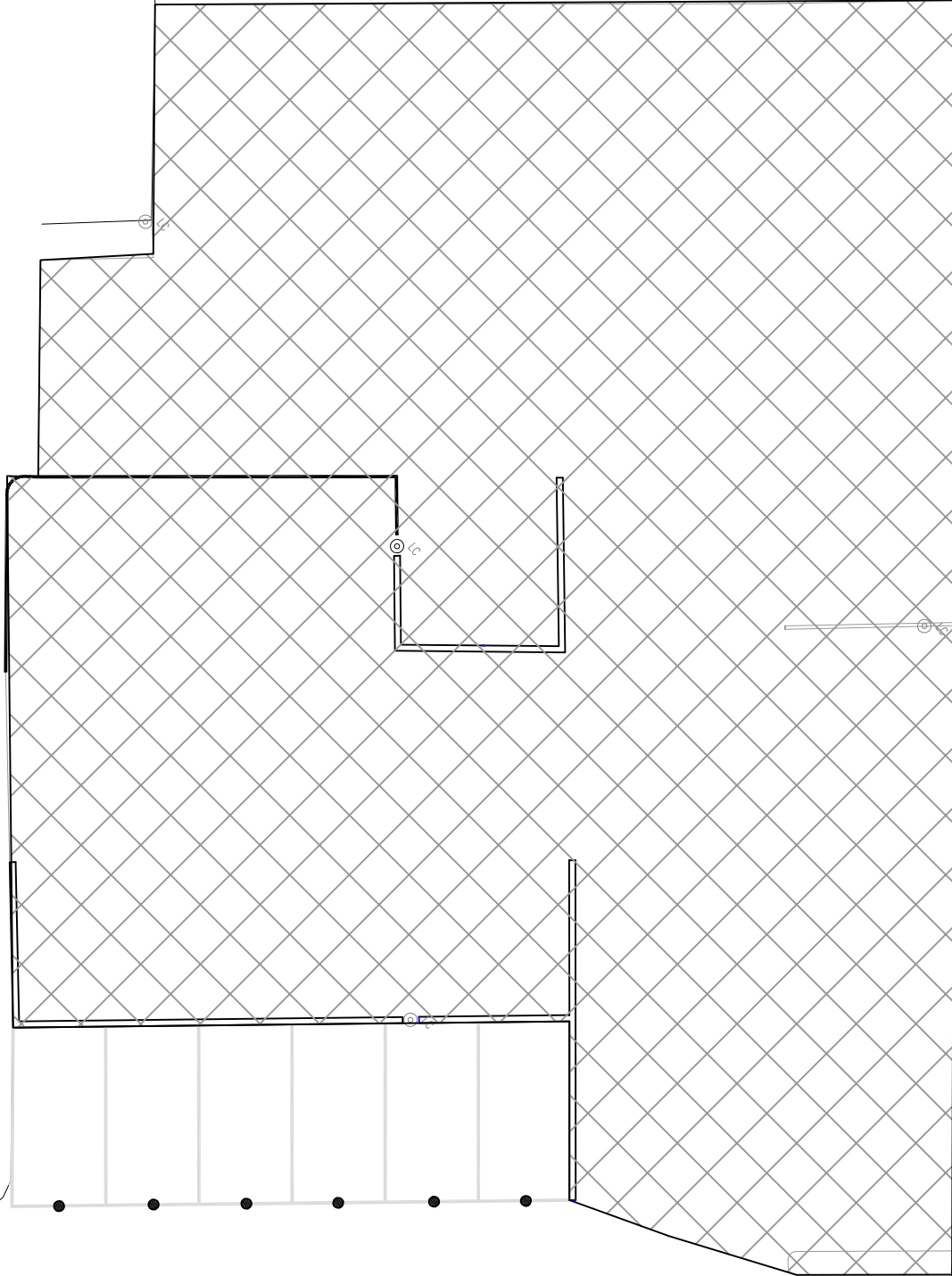

Brigade Close

This map is reproduced from or based upon Ordnance Survey material with the permission of Ordnance Survey on behalf of the Controller of Her Majesty's Stationery Office (c) Crown copyright. Unauthorised reproduction infringes Crown Copyright and may lead to prosecution or civil proceedings. London Borough of Harrow 100019206.



COMMUNITY & ENVIRONMENT
TRANSPORTATION

P.O. Box 39, Civic Centre,
Harrow, Middlesex. HA1 2XA
Tel: 020 8863 5611
Fax: 020 8420 9611

Project

HOUSING PARKING CONTROLS

Title

Brigade Close Off-street Parking
Proposed Pay & Display
and Permit Holders only area

Scale

1:200
@ A3

Drawn RLM

Date 20/07/12

Checked

PN

Drawing no

T/DWG/00375

Autocad file

O:\TRAFFIC\PARKING&STT\CPZ\Housing Pk Cntr
\Housing Parking Controls\Drawings\general plan 2004.dwg

NORTHOLT ROAD

97

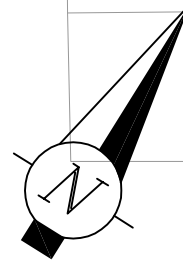

1 to 14

Existing height restriction barrier to be kept h= 2.00metres

Existing access gate to be removed

Existing post to be disposed of

Existing post to be disposed of

Cowen Avenue

Key:



Parking area for Permit Holders only

This map is reproduced from or based upon Ordnance Survey material with the permission of Ordnance Survey on behalf of the Controller of Her Majesty's Stationery Office (c) Crown copyright. Unauthorised reproduction infringes Crown Copyright and may lead to prosecution or civil proceedings. London Borough of Harrow 100019206.



COMMUNITY & ENVIRONMENT TRANSPORTATION

P.O. Box 39, Civic Centre, Harrow, Middlesex. HA1 2XA
Tel: 020 8863 5611
Fax: 020 8420 9611

Project

HOUSING PARKING CONTROLS

Title

Cowen Avenue Off-street Car Park Proposed Permit Holders Only area

Scale

1:200 @ A3

Drawn RLM

Date 20/07/12

Checked

PN

Drawing no

T/DWG/374

Autocad file

O:\TRAFFIC\PARKING&STT\CPZ\Housing Pk Cntr \Housing Parking Controls\Drawings\general plan 2004.dwg

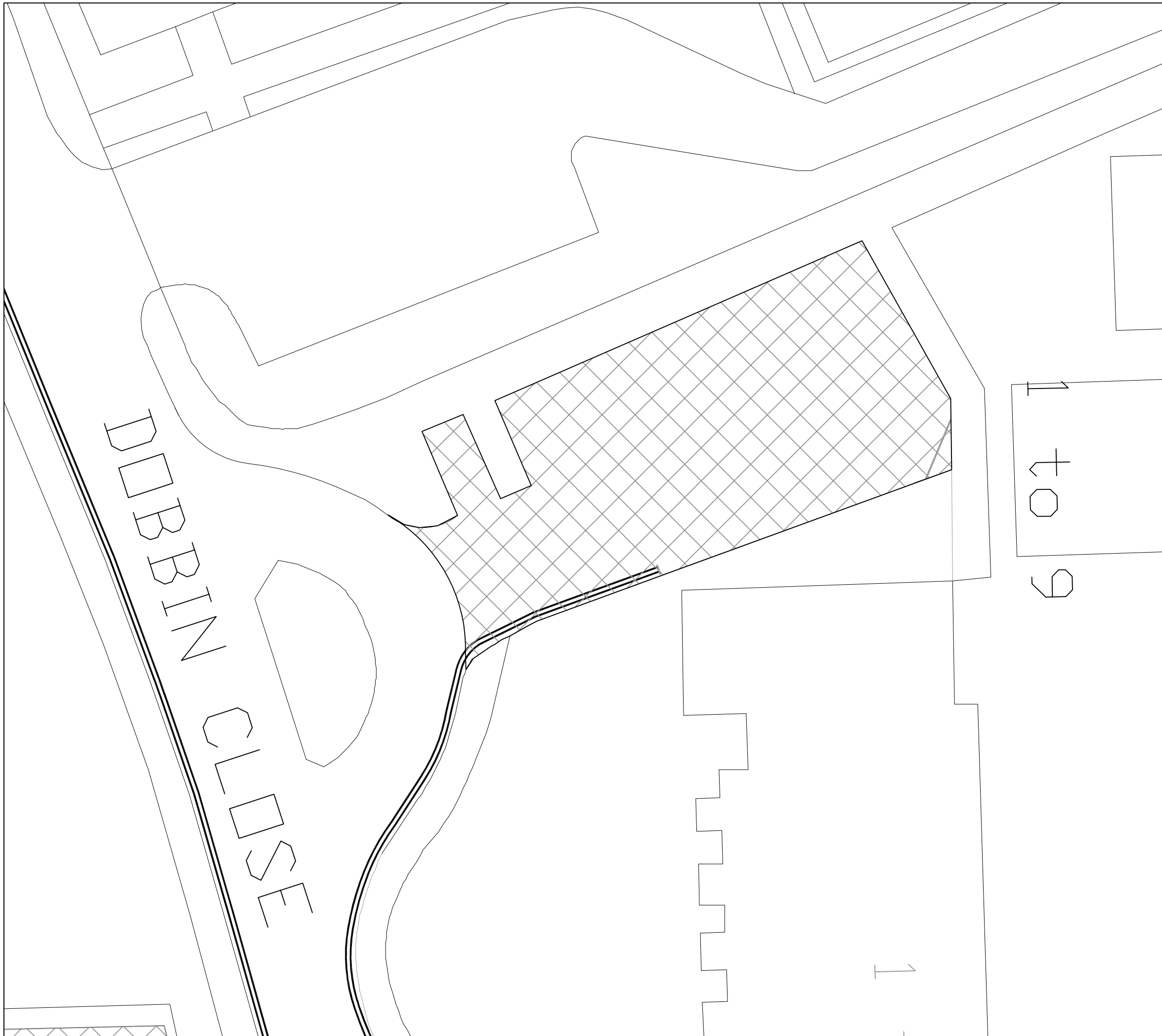

Key:

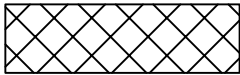

Parking area for
Permit Holders
only

This map is reproduced from or based upon rvey material with the permission of Ordnance Survey on behalf of the Controller of Her Majesty's Stationary Office (c) Crown copyright. Unauthorised reproduction infringes Crown Copyright and may lead to prosecution or civil proceedings. London Borough of Harrow 100019206.



COMMUNITY & ENVIRONMENT
TRANSPORTATION

P.O. Box 39, Civic Centre,
Harrow, Middlesex. HA1 2XA
Tel: 020 8863 5611
Fax: 020 8420 9611

--	-----	-/-/-	--
Designation	Details of Revision	Date	Sign

Project
**HOUSING PARKING
CONTROLS**

Title
**DOBBIN CLOSE 1
PROPOSED PERMIT HOLDERS
ONLY AREA**

Scale 1:200 @ A3	Drawn RLM	Checked
	Date 14/09/12	PN

Drawing no
T/DWG/000377a

Autocad file
O:\TRAFFIC\PARKING&STT\CPZ\Housing Pk Cntr
\Housing Parking Controls\Drawings\general plan 2004.dwg

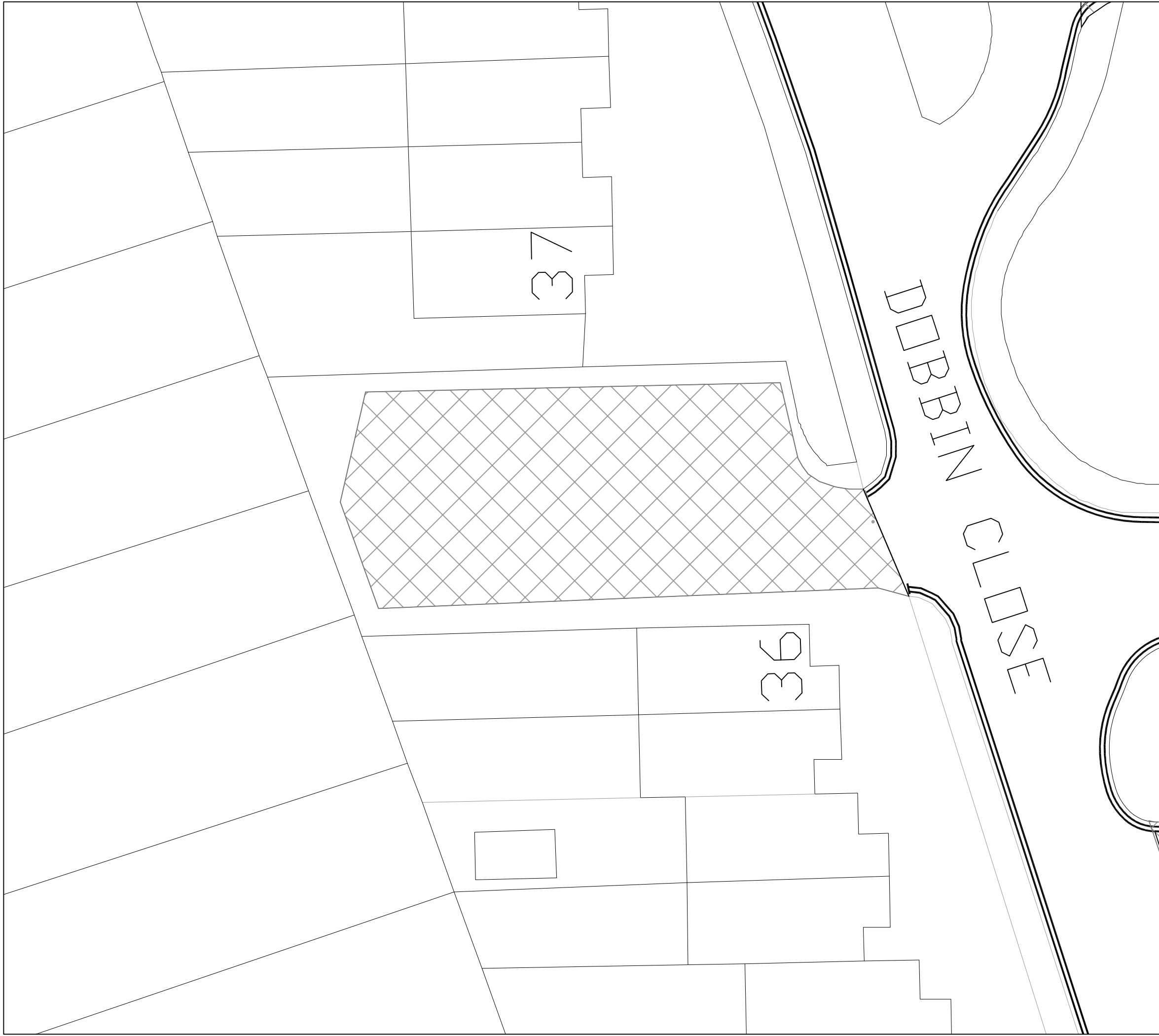

Key:

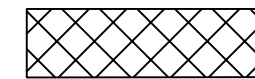

Parking area for
Permit Holders
only

This map is reproduced from or based upon any material with the permission of Ordnance Survey on behalf of the Controller of Her Majesty's Stationery Office (c) Crown copyright. Unauthorised reproduction infringes Crown Copyright and may lead to prosecution or civil proceedings. London Borough of Harrow 100019206.



COMMUNITY & ENVIRONMENT
TRANSPORTATION

P.O. Box 39, Civic Centre,
Harrow, Middlesex. HA1 2XA
Tel: 020 8863 5611
Fax: 020 8420 9611

--	-----	-/-/-	--
Designation	Details of Revision	Date	Sign

Project

**HOUSING PARKING
CONTROLS**

Title

**DOBBIN CLOSE 2
PROPOSED PERMIT HOLDERS
ONLY AREA**

Scale 1:200 @ A3	Drawn RLM	Checked
	Date 14/09/12	PN

Drawing no
T/DWG/000377b

Autocad file
O:\TRAFFIC\PARKING&STT\CPZ\Housing Pk Cntr
\Housing Parking Controls\Drawings\general plan 2004.dwg

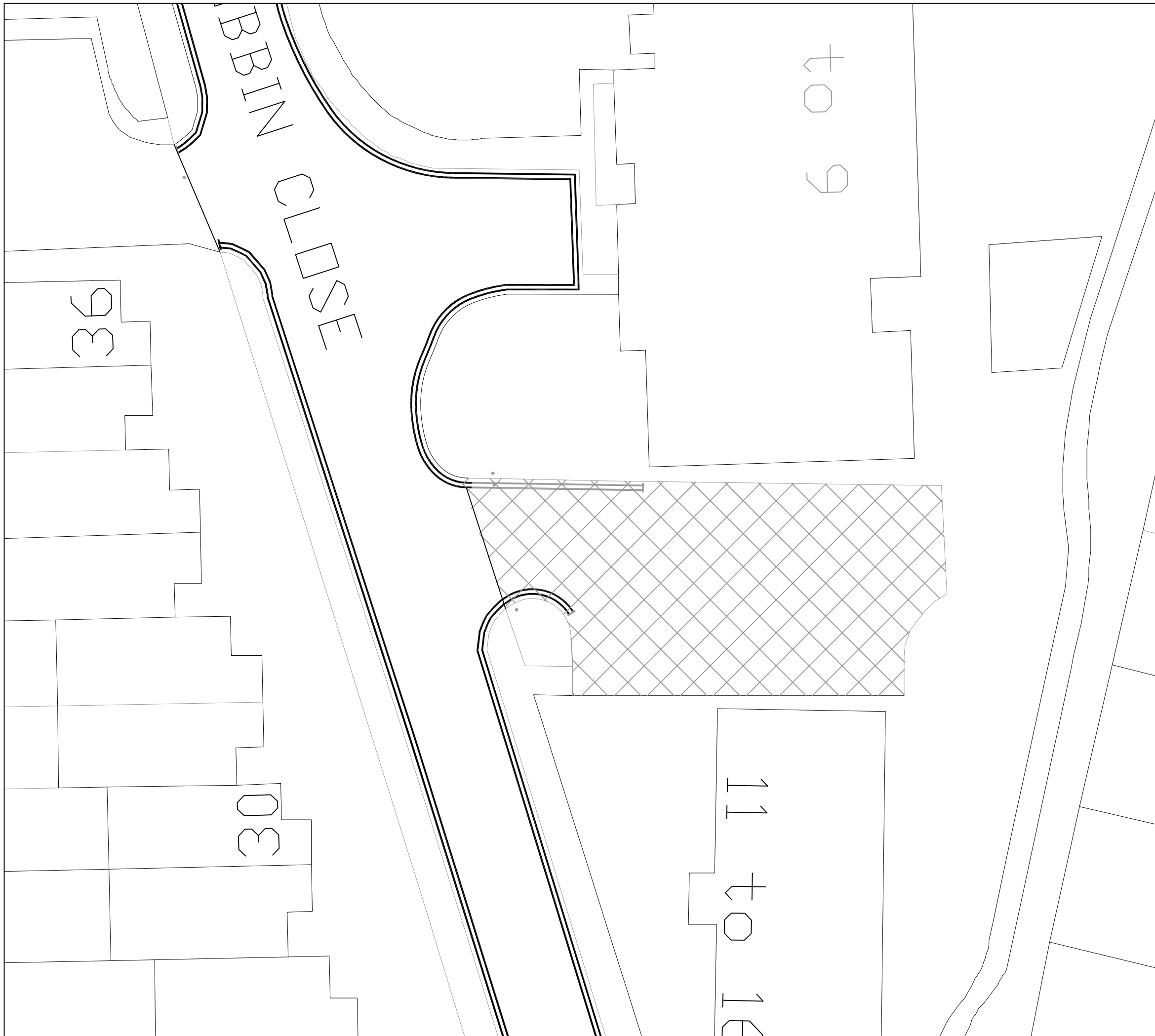

Key:



Parking area for
Permit Holders
only

This map is reproduced from or based upon rvey material with the permission of Ordnance Survey on behalf of the Controller of Her Majesty's Stationery Office (c) Crown copyright. Unauthorised reproduction infringes Crown Copyright and may lead to prosecution or civil proceedings. London Borough of Harrow 100019206.



COMMUNITY & ENVIRONMENT
TRANSPORTATION

P.O. Box 39, Civic Centre,
Harrow, Middlesex. HA1 2XA
Tel: 020 8863 5611
Fax: 020 8420 9611

--	-----	-/-/-	--
----	-------	-------	----

Designation	Details of Revision	Date	Sign
-------------	---------------------	------	------

Project

HOUSING PARKING CONTROLS

Title

DOB BIN CLOSE 3 PROPOSED PERMIT HOLDERS ONLY AREA

Scale	Drawn RLM	Checked
1:200 @ A3	Date 14/09/12	PN

Drawing no
T/DWG/000377c

Autocad file
O:\TRAFFIC\PARKING&STT\CPZ\Housing Pk Cntr
\Housing Parking Controls\Drawings\general plan 2004.dwg

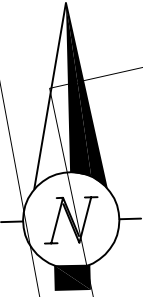
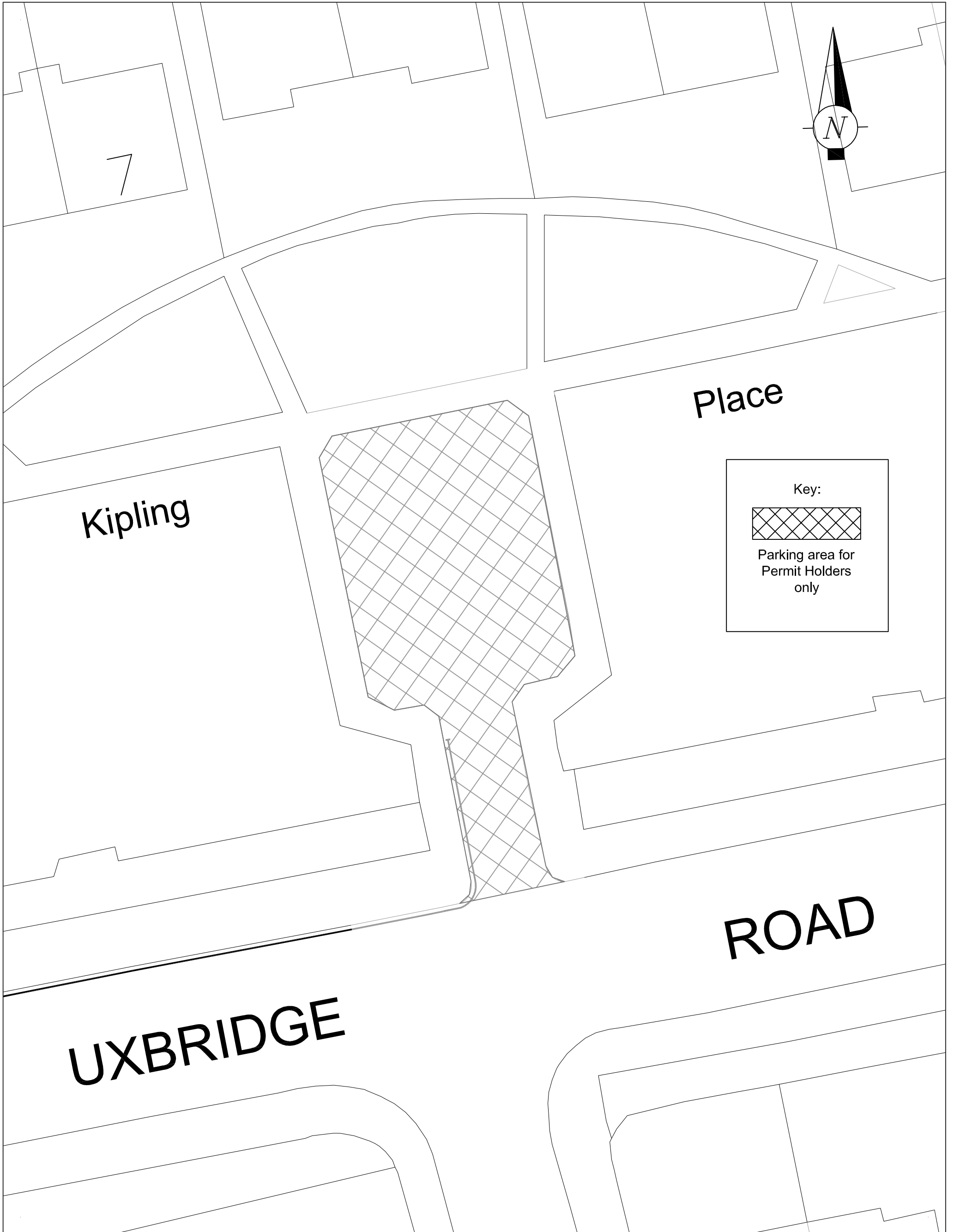

7

Kipling

Place

Key:

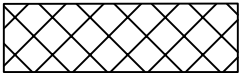

Parking area for
Permit Holders
only

ROAD

UXBRIDGE

This map is reproduced from or based upon Ordnance Survey material with the permission of Ordnance Survey on behalf of the Controller of Her Majesty's Stationery Office (c) Crown copyright. Unauthorised reproduction infringes Crown Copyright and may lead to prosecution or civil proceedings. London Borough of Harrow 100019206.



COMMUNITY & ENVIRONMENT
TRANSPORTATION

P.O. Box 39, Civic Centre,
Harrow, Middlesex. HA1 2XA
Tel: 020 8863 5611
Fax: 020 8420 9611

Project

HOUSING PARKING CONTROLS

Title

Kipling Place Off-street Car Park
Proposed Permit Holders Only area

Scale

1:200
@ A3

Drawn RLM

Date 20/07/12

Checked

PN

Drawing no

T/DWG/00378

Autocad file O:\TRAFFIC\PARKING&STT\CPZ\
Housing Parking Controls\Drawings\
general plan 2004.dwg

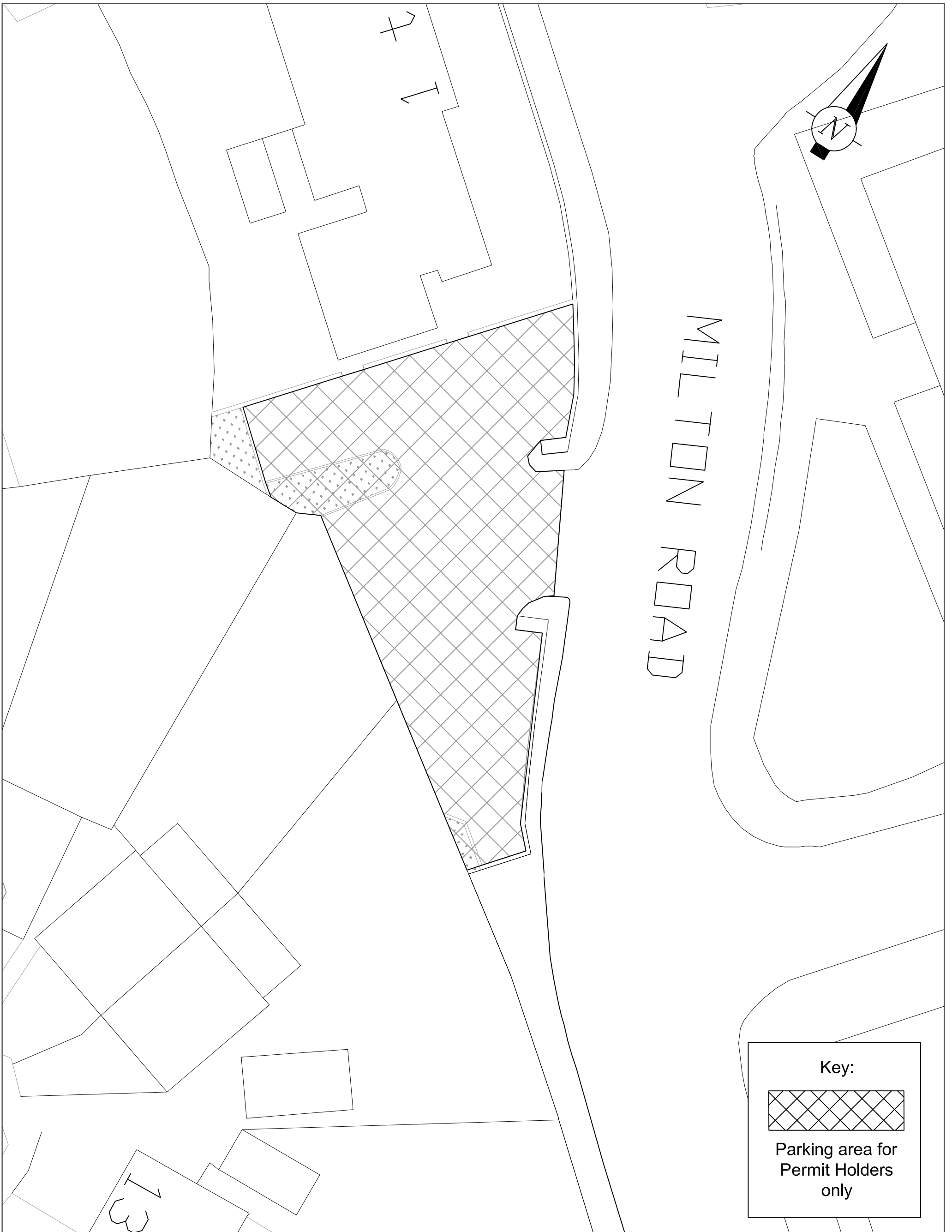

This map is reproduced from or based upon Ordnance Survey material with the permission of Ordnance Survey on behalf of the Controller of Her Majesty's Stationery Office (c) Crown copyright. Unauthorised reproduction infringes Crown Copyright and may lead to prosecution or civil proceedings. London Borough of Harrow 100019205.



Harrow COUNCIL
LONDON

COMMUNITY & ENVIRONMENT
TRANSPORTATION

P.O. Box 39, Civic Centre,
Harrow, Middlesex. HA1 2XA
Tel: 020 8863 5611
Fax: 020 8420 9611

Project
HOUSING PARKING CONTROLS

Title
**Milton Road Off-street Car Park
Proposed Layout**

Scale 1:200 @ A3	Drawn RLM Date 20/07/12	Checked PN
Drawing no T/DWG/00379		
Autocad file O:\TRAFFIC\PARKING&STT\CPZ\HousingPkCnt \Drawings\general plan 2004.dwg		

FE

SANDRIDGE CLOSE

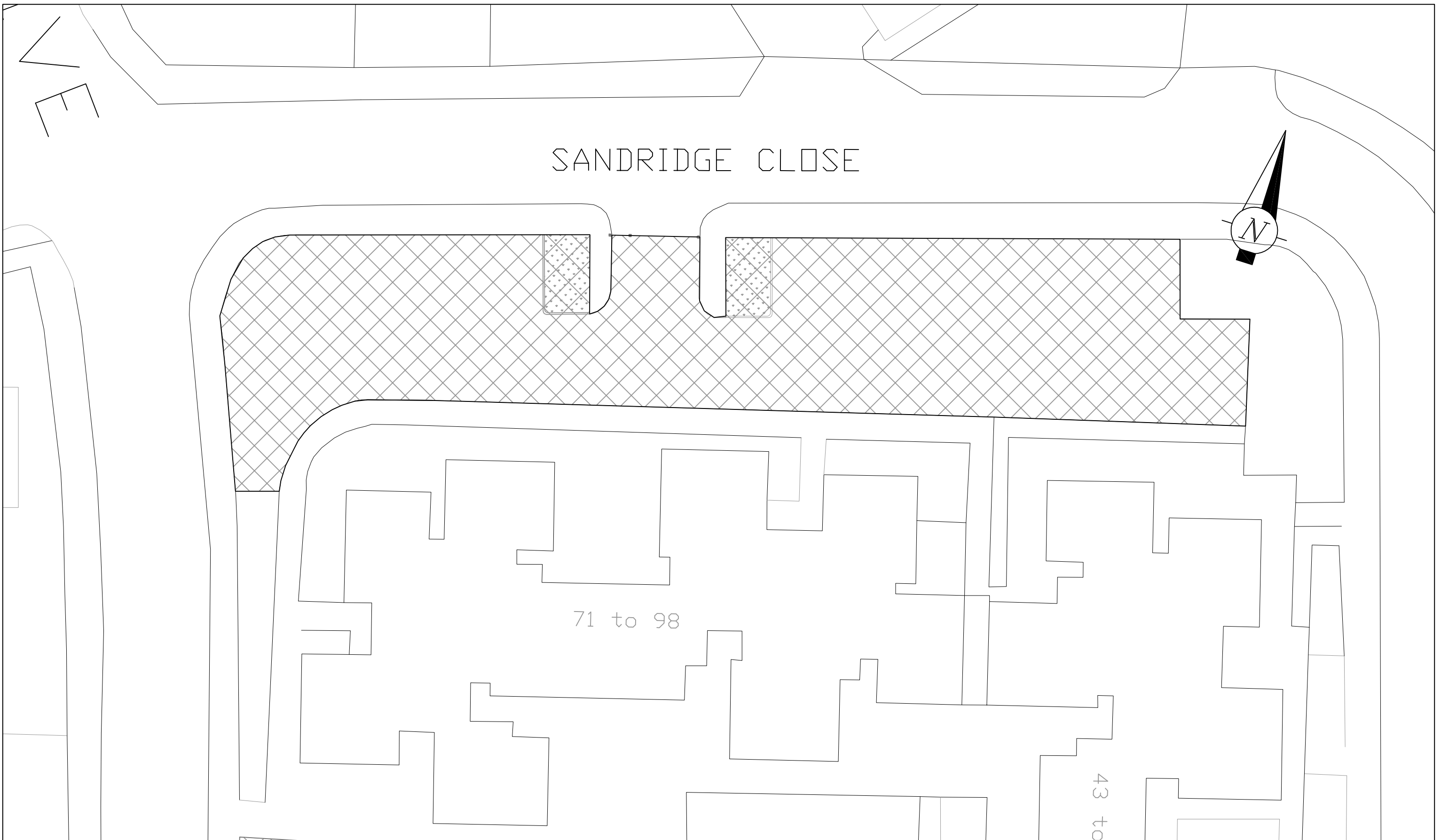
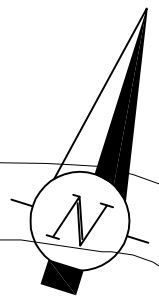

NOTES:

This map is reproduced from or based upon Ordnance Survey material with the permission of Ordnance Survey on behalf of the Controller of Her Majesty's Stationery Office (c) Crown copyright. Unauthorised reproduction infringes Crown Copyright and may lead to prosecution or civil proceedings. London Borough of Harrow 100019206.



Harrow COUNCIL
LONDON

COMMUNITY & ENVIRONMENT
TRANSPORTATION

P.O. Box 39, Civic Centre,
Harrow, Middlesex. HA1 2XA
Tel: 020 8863 5611
Fax: 020 8420 9611

Designation	Details of Revision	Date	Sign

Key:



Parking area for
Permit Holders
only

Project	HOUSING PARKING CONTROLS
Title	Sandridge Close Off-street Car Park Proposed Permit Holders Only area

Scale	1:250	Drawn	RLM	Checked
	@ A3	Date	14/09/12	PN
Drawing no		T/DWG/000376a		
Autocad file				